

उत्तर प्रदेश ग्रामीण बैंक
Uttar Pradesh Gramin Bank

SHORT TERM TENDER NOTICE

(For Empanelled Furnishers and Interior Decorators)

**FURNISHING WORKS FOR GADDOPUR BRANCH REGION-
AYODHYA**

IMPORTANT DATES

DATE OF ISSUE OF TENDER	05.08.2025
LAST DATE AND TIME OF SUBMISSION OF TENDER	11.08.2025 up to 04:00 PM
DATE OF OPENING OF TENDER (FINANCIAL BID)	12.08.2025 at 04:00 PM

Uttar Pradesh Gramin Bank
Premises and Equipment Department
Regional Office Ayodhya
Baldev Niwas Compound, Acharya Narendra Dev Road Ayodhya-224001

Regional Manager

Date: 05.08.2025

NOTICE INVITING TENDER

Sealed item rates short term tenders are invited on behalf of the Regional Manager, Uttar Pradesh Gramin Bank, from the Furnishers & Interior Decorators having valid Empanelment for the work of FURNISHING WORKS at GADDOPUR Branch District- Ayodhya.

- 1. Issue of tender documents:** 05.08.2025 to 11.08.2025 up to 04:00 PM
- 2 Last date of receipt of tender documents:** 11.08.2025 up to 4.00 PM.
- 3 Date of opening of tender documents:** 12.08.2025 at 4.30 PM.
- 4 Place of submission & opening of tender:** Uttar Pradesh Gramin Bank , Regional Office Ayodhya.
- 5. Name of Architect:** Gunjan and Associates (Mob: 9838818489)
- 6. Period for completion of work from order date:** Maximum 30 days.
- 7. Retention percentage:** 10% (Ten percent) from final bill.
- 8. Defect liability period:** 12 months from the date of completion certificate issued by the Bank Architect.
- 9. Release of retention money:** After 14 days from defect liability period.
- 10. Commencement of work:** Within 7 days of issue of work order.
- 12. Period Of Completion:** 30 days from the date of issue of work order (A penalty of Rs100/day will be imposed for further delay).
- 13. A deviation of $\pm 10\%$ will be allowed in the final work order amount, to accommodate unforeseen changes during furnishing works.**

SUBMISSION OF TENDER

The tenders are to be submitted in a sealed envelope and clearly super scribed as

"Tender for FURNISHING WORKS of GADDOPUR" branch and to be submitted at Uttar Pradesh Gramin Bank, Regional Office, Baldev Niwas Compound, Acharya Narendra dev Road, Ayodhya- 224001 (U.P.)

ENVELOPE TO BE CONTAINED

Envelope shall contain the priced Tender Volume

GENERAL INSTRUCTIONS TO TENDERERS

- 1 The term "Employers" or "Bank "shall mean "Uttar Pradesh Gramin Bank, or its authorized representatives at Uttar Pradesh Gramin Bank, Regional Office Ayodhya, District-Ayodhya.
2. The term "Architect shall mean "M/s Gunjan and Associates who is the Architect Consultant to the Employer for this project & having office at 141. Sainik Nagar, Raibareilly Road, Lucknow-226002 or its authorized representatives.
3. The term "Contractor" shall mean the successful tenderer to whom the Contract shall be awarded.
4. The "Works" shall mean the "FURNISHING WORKS AT GADDOPUR BRANCH REGION-AYODHYA, DISTRICT-AYODHYA
5. The Contractor should quote the rates in figures and words. Any corrections or Over-writing should be initialed by the Contractor.
6. The Contractor should submit the tenders with seal, signature and date on each Page.
7. The Contractors should submit the cost of the main items as per tender specifications. Further modification after awarding of the contract shall be not allowed unless there is specific instruction by the Bank/Architect to change specifications.
8. The contract is time-bound and the works are to be completed within the time limit specified in the notice inviting tenders. This is a working office and the contractor has to work with no or minimum obstruction to its regular services.

9. The decision of Employer and the Architect is final and binding.

TERMS & CONDITIONS

1. Unless otherwise mentioned, all works are with no allowance for Lapse waste. Unless otherwise described or measured separately, price for all the items shall include all necessary straight & curved edges.
2. Any damage to the work before the site is handed over, is to be replaced or made good at the expense of the contractor to the entire satisfaction of the Architect/Bank.
- 3 Income Tax, Other Tax as applicable shall be deducted at source as per the Income Tax Act/Rules.
4. The quantities indicated are subject to change. The payment of the bill shall be made as per the actual measurement as certified by the architect but not exceeding the total value quoted in the tender form.
5. The Architect or any officer of the Employers will be free to inspect the work at the site during the period of execution any suggestion of change or modification to improve the quality of work will be carried out subject to prior approval of the competent authority of the employers and that of the Architect.
6. In case of failure to take up the work even after accepting the work order, or leaving the work incomplete, or for defective work not rectified, or violation of the terms and conditions, the contractor will be de-panel/blacklisted.
7. For any item of work not covered or any unforeseen items of work, payment will be made according to the rates approved for similar nature of work, the costing done by the Architect, as per current PWD schedule of rates, or as per analysis of material cost,
8. The tenderers shall sign each & every page of the tender documents including the drawings attached here to.
9. The amount is to be quoted in figures as well as in words. In case the rates quoted in words and in figures are in variance, the amount written in words shall be taken as final.
10. The Contractor shall make their own arrangement at their own cost for storing materials, plants, tools etc. The employers will not be liable for security of the Contractor's materials.

11. No tools or plants will be issued by the bank.
12. The Employer / Architect reserves the right to accept or reject any tender without assigning any reason whatsoever and the said decision shall be final and binding upon the tenderer.
13. In case of breach of contract by the Contractor for slow progress of works or any other claim of damage, the Employer or the Architect may have the power to rescind the contract without furnishing further reasons thereof.
14. The Architect shall have the power to ask the contractor to furnish the sample/ colour / test certificate from any Govt. /Authorized agent for any materials used/ to be used in the Works, the expenditure of which is to be borne by the Contractor.
15. The Employer shall be not be liable for any damages or compensation payable as a consequence of any accident or injury to any workman or other persons in the employment of the Contractor or any sub-contractor.
16. On completion of the Works, all rubbish, debris, materials, tools, Labourers, etc. to be removed by the contractor from the site and the contractor will hand over the site clean & clear & in usable condition within 3 days of completion of the works. Failing this, the employer may dispose the materials at the cost of the contractor.
17. In case of any dispute, the matter will be referred to the General Manager, Uttar Pradesh Gramin Bank, Head Office NBCC commercial, Vardan Khand Gomti Nagar Extension Lucknow-226010.
18. Final Payment after completion of Project will be done with the certificate of Architect with deduction of retention money by the Bank.
19. The rates quoted in the tender shall exclude GST but include all excise tax, octroi & other taxes, no escalation of rates will be allowed under any circumstances.
20. If the work is not completed within the stipulated time, a penalty of Rs 100/- per day will be imposed till the completion of works.

ARCHITECT

Gunjan And Associates
141, Sainik Nagar, Raibareilly Road
Lucknow-226002

Gunjan and Associates
Architects, Engineers, Interiors
& Landscape Designers

141, Sainik Nagar, Raibareilly Road, Lucknow-226002

Phone: 0522-3553324, 9839018489, 9838818489

E-mail: studio@gunjanandassociates.com

URL: www.gunjanandassociates.com

Bill of Quantity for Furnishing works for Uttar Pradesh Gramin Bank

Branch at Gaddopur

Region - Ayodhya

1.No offsite prefabrication shall be allowed in any case. All fabrication shall be done at the site after getting the materials inspected by the architect

2.No payment shall be made for any in completed or unsatisfactory work

3.The Contractor should strictly follow the Booklet requirements of the Bank

including the detailed drawings in the booklet. Any discrepancy between the booklet and the Specifications below should be brought to the notice of the Architect.

4. List of material to be strictly as per the booklet.

5. Cable Managers to be provided in the tables and Counters wherever required.

6. All underframe should be properly treated with antitermite and waterproofing material

7. All Locks in the drawers and door etc. should be of Godrej

8. All keyboard Trays and Drawers to be on Channel Sliding Mechanism.

***The contractor to follow the banks colour Coding. Any other specified colour to be superceded by the Banks Colour code.**

***All board to be BWP. Of approved brand and if written BWR it should be superceded by BWP board/ply.**

S.No.	Description of item	Unit	Qty.	Rate	Amount
1	Branch Manager Table with Side Table and 12mm thick toughened glass on top	NOS.	1.00		
	Size -5'-0" (L) X 2'-6" (W) X 2'-6" (H) Providing and placing in position table made of phenol bonded 19mm thick commercial board with top front and sides finished in 1.0 mm Thick laminate and 12mm thick toughened glass on top. The front facade of the table to have 6 mm thick and 29 mm wide moulding. Every table shall be provided with a key board, drawer, and a cabinet with a shutter below W-375mm, H-750mm, Depth- 500mm. The storage unit shall consist of provision for C.P.U. 600X250 size Keyboard to be made of 19 mm thick commercial board and finished Drawers and a cabinet with a shutter below W-375mm, H-750mm, Depth-500mm. shall consist of 12 mm thick commercial board for bottom, sides and back of 19 mm thick phenol bonded commercial board with laminate in front and shall slide on tray system provision (sliding mechanism).				
	All the units shall be provided with all the necessary hardware as approved by the Architect. such as knobs, handles, etc. All unexposed surfaces to have two coats of synthetic enamel paint with primer and base, all complete, specifications and directions of the engineer in charge.				
2	Cash Cabin Partition (HT-7'-0" ONLY)	Sq.ft.	185.00		

	Providing and fixing of Cash Enclosures at height of 7'-0" with Anodized aluminium frame work, heavy sections (2mm thickness) of 1.75"x1.75", spacing of 2'0"x2'0" on bothsides and covered 6mm thick BWP plywood finished with 1mm thick laminate of approved colour. Partition shall have provision for opening and 19mm BWP plywood tray for challan receiving purpose. Cost include aluminium grill and fixed with teak wood beading and duco paint. Cost also include 3 Nos of Solid core flush Doors with sizes of 2'6"x7'0", fixed in the partition. Door shall have teak wood beading and lipping with duco paint. Door finished with 1mm thick laminate of approved colour for skirting of approved pattern. Door shall have 8mm glass fixed with teak wood beading and duco paint. Rate to include hardware's like brass hinges, godrej three nos of night latch, door closure, door stopper and handles. Cost also include cash transaction opening shall be provided with door arrangements made with BWP plywood frame work finished by laminate, duco paint and locking system. Cost include wastages, transports, loading, unloading charges, labours, materials, tools, lead, lift and etc. Complete as per drawings and instructions of the Architect.				
	Decorative Grill (12mm thk)-hexagonal opening as per instruction of Bank's Engineer/Architect.) All exposed edges of Plywood shall be fixed with 1/8" C.P. Teak Lipping.				
3	Cash Counter	Rft.	5.00		
	Bank counter of approved design for cashier made of 19.00 mm commercial block board and mica 1.00 mm thick of approved brand and colour on front customer top and writing desk. Height of counter from customer side 114cm (45"). width of writing desk 75cm.(30") with provision of cupboard after every 1.20 mts made of 19.00 mm block board with 1.0 mm sunmica pasted on both side (inner and outer), and teakwood beading complete with quality polish finish. Mica pasted on both sides external & internal including all locks & handles with door closer.				
4	Front Counter	Rft.	23.00		
	Front counter made of 19.00 mm block board with table top at the height 75 cm and 80 cm wide sunmica 1.0 mm on top and cup board and sliding key board with provision of fixing of glass in front. Mica pasted on both sides external & internal including all locks & handles.				
5	Cash Cabin-Aluminium Grill Top with teak Decorative Grill Partition).	SQFT	45.00		
	Providing and fixing of Aluminum grill work in cash counter top with all nessecary fixing support of 'L', 'H' and 'C' aluminium sections and etc. Cost include 'L', 'H' and 'C' aluminium sections, hardwares, tools, wastages, lead, lift, labour charges, loading, unloading charges, cutting, transport and etc. Complete as per instructions of the Architect.				
6	12 mm Glass on Front Counter & Cash Counter	Sq.ft.	55.00		

	12 mm float glass with rounded edges with etching as per the requirement of bank for Front counter (Height: 60 cms) (With teak wood frame 70 cm).				
7	Low Height Partition up to 4'-6" ht. glazed/Unglazed partition	Sq.ft.	252.00		
	Half Height partition to be made with Anodized Aluminium frame work, heavy sections (2mm thickness) of 1.75"x1.75" sections, spacing of 2'0"x 2'0" on both sides and covered with 9mm thick BWP plywood finished with 1mm thick laminate of approved colours for skirting & borders and white colour laminates for base on both sides with all necessary fixing accessories, arrangements and etc. Partition shall be block partition till 3' ht. and 1'-6" glazing. It shall have 12mm thick etched glass and fixed with teak wood beading with melamine polish. Clear glass shall be finished with frosted film sticking over the glass of approved pattern and design. Rate to include providing cutouts and provisions to run electrical conduits, switches, etc. Cost include wastages, transports, loading, unloading charges, labours, materials, tools, lead, lift and etc. Complete as per drawings and instructions of the Architect.				
8	Storage (Low Height)	Sq.ft.	32.00		
	Size-2'-6" high X 1'-6" deep				
	Ply Wood -19.0mm thick board for side top and door & back 6.0mm IS 303 with shutters, shelf 19.0mm ply				
	Shelf-19.0mm thick MR Grade IS303 ply				
	Handle-Brush finish stainless steel				
	Lock-Vijayan/Godrej				
	Internal surface zinc oxide polish and other required accessories instructed by Bank's Engineer/Architect.				
9	Column / Wall Panelling / Meter Boxing	Sq.ft.	120.00		
	Providing & fixing in position 2"x 2" kailwood frame and finished with 6 mm thk. Commercial ply on both sides with 1.0 mm thk. Laminate on top as per instruction of the Architect. column panelling only 8.5' height				
10	Notice Board	No.	1.00		
	Notice Board made of 19.00 mm board (size: 3'-0"x3'-0") laminated sides and covered by good quality Cherry Colour Velvet with attached Cheque Writing Desk (6"x6"x9") with attached Two Battens for Support, Sunmica Pasted on all sides.				
11	Writing Desk Including Suggestion Box and Cheque Drop Box	No.	1.00		
	Writing ledge of 19 mm Phenol bonded board as/design on 19 mm thick with pockets for slips of 6mm glass machine polished with separators completed to the satisfaction of the architect and the Drawing. The Writing ledge includes a Suggestion box below, cheque drop box and a notice board above complete to the satisfaction of the Architect.				

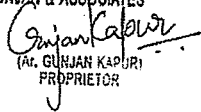
12	Hydraulic Door Closure. (to be Godrej)	No.	1.00		
	Providing and fixing of hydraulic door closure (Make-Godrej, Product Code-4539 or equivalent) for doors. It shall incorporate the following –				
-	Body manufactured from Aluminium extruded alloy machined to extreme accuracy.				
-	Rack and Pinion-made of machined alloy steel duly heat-treated.				
-	Adjustable closing speed.				
-	Suitable for right hand and left hand opening doors.				
-	Suitable for door / frame mounting.				
-	Suitable for door weight up to 60 kgs.				
-	Suitable for 180 / 100 degree door opening.				
-	All complete to the satisfaction of the Architect.				
	Total				
Note: All rates are excluding G.S.T.					
<div style="text-align: right;"> For GUNJAN & ASSOCIATES  <small>(AR. GUNJAN KAPUR) PROPRIETOR</small> </div>					
<div style="text-align: right;"> Ar. Gunjan Kapur for Gunjan & Associates </div>					

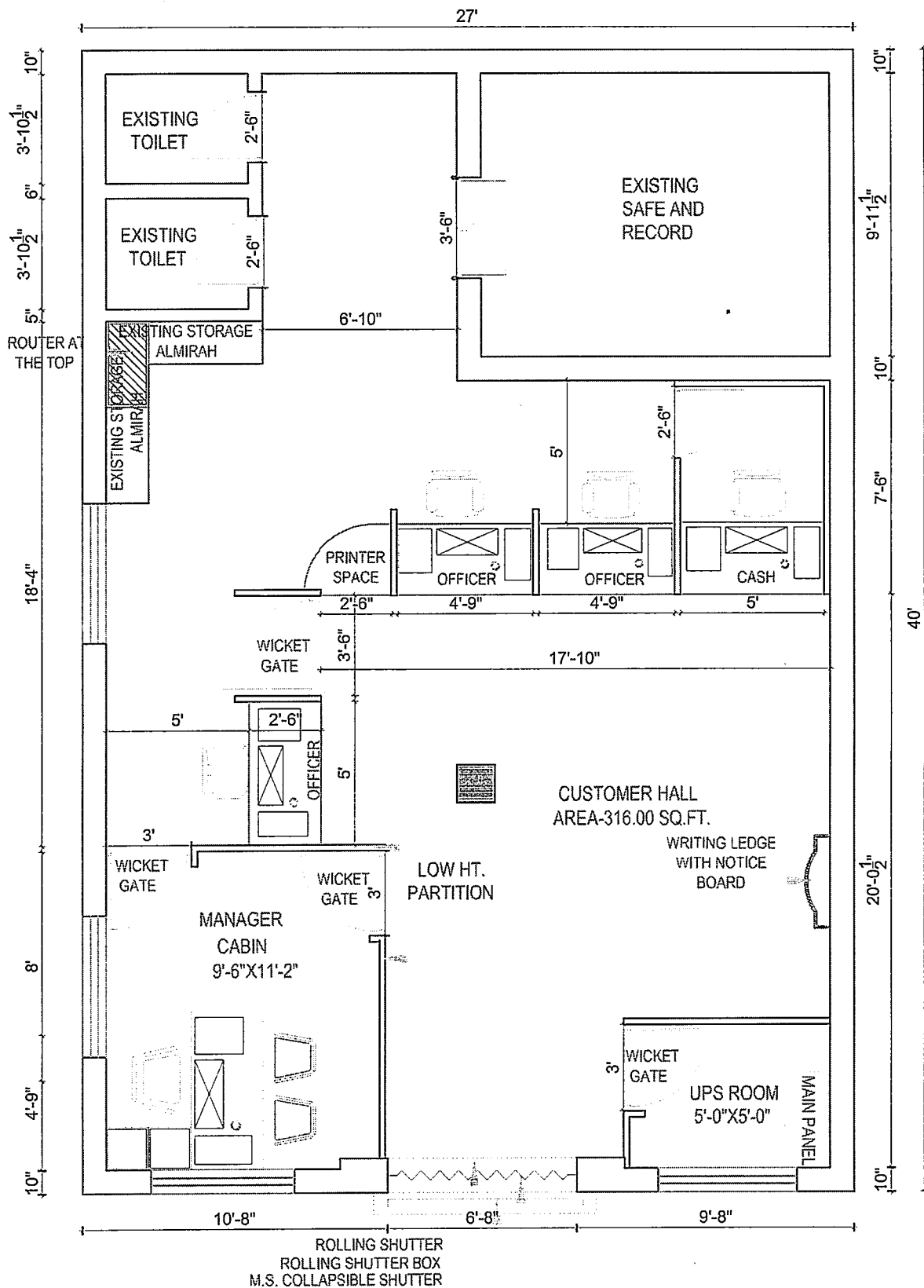

PROJECT:-

REVISED LAYOUT PLAN
FOR UTTAR PRADESH
GRAMIN BANK BRANCH
AT, GODDOPUR
R.O. AYODHYA.

DRG. TITLE:-

GROUND FLOOR
PLAN

DATE:-

AUG -2025

NORTH:-

DRAWN BY:-

ARCHITECT:-

GUNJAN & ASSOCIATES
ARCHITECTS, ENGINEERS, INTERIOR
AND LANDSCAPE DESIGNERS.
141, SAINIK NAGAR, LANE NO-9,
RAEBARELI ROAD LUCKNOW-226002
Telephone No:- +0522-3553324
Phone No:- +9838818489, 9839018489
E-Mail:- studio@gunjanandassociates.com
Web:- www.gunjanandassociates.com

BARODA U.P BANK**LIST OF MATERIALS OF APPROVED BRAND AND/OR MANUFACTURER**

1. The contractor shall use materials in their work subject to inspection, prior to dispatch, by Owner or his authorized representative of any materials not otherwise specified, shall be in Accordance with the following list. All materials not otherwise specified shall be in accordance With the latest Indian Standard Specifications, where such exists with prior approval of Owner /Architects. The contractor shall be bound to offer sample of materials, which are claimed to be conforming to I.S Specification, for testing at an approved testing laboratory.
2. Contactor shall purchase all materials from the makers or their authorized stockist only. Necessary documentary evidences must be produced to the Owner or their authorized Representative on demand.
3. Contractor shall be bound to supply items or any make of the items as per the choice of the Owner/ Architects.

A CIVIL / FURNISHING WORK

S.No	Description	Approved Brand/ Manufacturer
1.	Cement	M/s ACC, M/sPrism ,M/s Jaypee
2.	Wood	First class Steam beach wood or as specified
3.	Polish	MRF Polyurethane
4.	Termite treatment	Chloroporyphos 20% concentration / Dusban /Terminator pidlite make
5.	Soft Board	Celotex
6.	Flase Ceiling and Sections	Grid Tiles ---Armstrong, St Gobain Gypsum India,
7.	Aluminium sections	Hindalco, Jindal, Indal
8.	Vitrified Floor tiles	RAK Asian, Regent, Kazaria, nitco
9.	Block boards / Plywood/Flush doors	M/s Green (BWP) Tajpuria (BWP), M/s Century BWP, M/s Archid (BWP) No alternate brands from the same manufacturer allowed
10.	Laminates	M/s Green, lam (New Mika), M/s Merino, M/s Century, M/s Archid , Sunmica
11.	Hardware-(Aluminium)	Approved design, brand, quality & manufacture allowed
12.	Hardware	ALL HARDWARE TO ONLY GODREJ
13.	Drawer/ cabinet Handless/locks	Dorset / Kitch/ Godrej/ hettich
14.	Magnet Catcher	Supreme, Excel
15.	Drawer / cabinet shutter Accessories	Ebbco, Hettich, Hafele
16.	Synthetic Enamel Paints, Distemper or Plastic paint Best quality of make as approved	Asian Paints Ltd), Berger Paints (India) Ltd.(Luxol), ICI, Nerolac.
17.	Venetian blinds/ verticals	vista
18.	Glazing	M/s Modiguard, M/s asahi india, Saint Gobain.
19.	Door Closer/ floor spring	Godrej, Dorma, Ozone
20.	Glue Addhessive	Fevicole, Century
21.	Door handles/ Locks	Godrej
22.	Screw	Excel GKW
23.	Glass brass bracket	Flora, Perfect
24.	POP bag or readymade work	Diamond (Super fine quality)
25.	GI section for Partitions, Panel, false ceiling	Same Company as of Gypsum Bard or Mineral Fibre tiles
26.	Film	Alkor, Garware, 3M
27.	Plants	
28.	Wire management holes	Twinkle
29.	Cement Board	E board. Bison,

30.	Vitrified floor tiles adhesive / Grout	Bal Endura, Dr. Fixit Fevimate XL with Polymer Modified Mortar, ROFF Granite tile adhesive
31.	Texture	Spectrum , Heritage, Acro paint
32.	Upholstery	Raymonds
33.	Sanitary Fixtures	Cera, Hindware, Parryware
34.	GI Pipes and accessories	TATA
35.	CI Pipes and accessories	NECO
36.	Plumbing Fittings	Jaquar Continental series
37.	Ceramic Tiles	Kajaria (High Lighter Concept)