

उत्तर प्रदेश ग्रामीण बैंक
Uttar Pradesh Gramin Bank

ROMAHOBA/P&E/295/2025-26

Date: 29.07.2025

Dear All Empanelled Electrical Contractors
Dear Sir,

ELECTRICAL WORK OF TIKRI BUJURG BRANCH IN MAHOBA REGION
(Only empanelled Vendors of Uttar Pradesh Gramin Bank can quote)

Uttar Pradesh Gramin Bank Mahoba Region invites your competitive rates for the ELECTRICAL work at the premises of following branch situated in Mahoba Region under the following terms and conditions.

S.NO.	BRANCH	BRANCH STATUS	REGION	PREMISES	ARCHITECT	PHONENUMBER
1	TIKRI BUJURG	Working Branch	MAHOBA	New	Corner & Edges Lucknow	9839089825

8279429396

TERMS AND CONDITION

Please submit your rates in a closed envelope under following terms and conditions: -

1	The rates quoted should be inclusive of all type of charges, expenses for the branch. The GST etc Shall be paid extra.
2	Please quote your competitive rate on the enclosed formats .
3	If it is found that the material used is not the same as mentioned in quotation then the bank has the right to reject the work and the material.
4	If any type of change is required in ELECTRICAL work it should be duly approved by the Regional Manager of MAHOBA Region.
5	If the rates quoted by you are accepted to the Bank, then the ELECTRICAL work is to be completed in given time, please ensure that if the work is not completed in given time, then the bank has the right to impose the penalty at the rate of 3.00% for 5 days delay.
6	Rates quoted will be valid for 90 days from the date of opening of quotation.
7	Please ensure the measurement, quantity, items are tentative and may increase or decrease as per the requirement of bank. The variation may be up to 20%.
8	After the work is completed, it will be duly verified by the Regional Manager, Mahoba Region, Branch Manager as well as the Architect authorized for supervision / verification of work M/S Corner & Edges Lucknow.
9	Please ensure that the bank will not provide any advance against the work order however payment in full or in parts will be made only after the work completed and verified by the Architect and Regional manager.
10	Bank will retain 5 % cost of bill for 180 days while making the payment to cover the defect liability period from the date of payment of final bill.
11	Please ensure that before starting the work at the branch, the raw material may be duly verified by the Regional Manager, Mahoba Region, Branch Manager & Bank Empanelled Architect.
12	The quotation in a closed envelope must reach at regional office, Mahoba Region positively on or before 18.08.2025 up to 4.30 PM.
13	Please ensure that quoting the lowest rate is not necessary, the bank may allow the work and in this regards the bank has the full right to accept or reject the one and all tenders without any notice.
14	Please submit your competitive rates in closed envelope positively on or before 18.08.2025 and the quotation will be opened on 19.08.2025 at Regional office, Mahoba Region at 03.00 PM in presence of committee members. All empanelled ELECTRICAL vendors (who quoted the rates) are requested to remain present at the time of opening of tenders. Please note that no separate invitation will be sent.



(Ajeet Kumar Shukla)
REGIONAL MANAGER

क्षेत्रीय कार्यालय: गाँधी नगर छतरपुर रोड महोबा 210427
Regional Office Gandhi Nagar Chhatarpur Road Mahoba 210427
email- ans.romahoba@boirrb.com

Architects Engineers & Valuers

Government of India Registered Valuer :

- Income Tax Reg. No. 282/2003 CAT-1 Immovable Property
- Institute of International Appraisers & Valuers
- Corporate Member of Institution of Engineers (India)
- Chartered Engineer Registration No. AM 082632/C/5
- Approved Architect (A.I.I.A. App.)
- Expert in Water Proofing for Multistoried Residential and Commercial Building
- Soil Testing, Cube Testing and Antitermite Treatment
- Member of Indian Road Congress

Fellowship Approved :

- Institute of International Appraisers and Valuers
- Institute of Valuers (India) Reg. No. IV-9321
- Indian Association of Structural Engineers
- Member of Consulting Engineer Association of India

**CORNER'S 'n' EDGES****Prop. Vivek Singh**

B.E. (CIVIL), M.I.E., (Arch.)
FIV., A.M.I.E., A.M.I.V., M.I.R.C.
CHARTERED ENGINEER

**PROJECT : QUOTATION FOR ELECTRICAL WORK IN TIKRI
BUJURG BRANCH RO MAHOBA**

S.NO.	DESCRIPTION OF ITEM	QUANTITY	UNIT	RATE (Rs.)	AMOUNT (Rs.)
	ELECTRICAL WORKS.				
a.	LIGHT, FAN, 6 AMPS., 6/16 AMPS.				
1	Primery Light, Fan & 6 Amps. Switch Points.	30	Nos.		
2	Secondry Light, Fan & 6 Amps. Switch Points.	30	Nos.		
3	Circuit Wiring (Light, Fan & 6 Amps. Switch Points).	100	Mt.		
4	6/16 Amps. Switch Socket.	12	Nos.		
5	Circuit Wiring (6/16 Amps. Switch Points).	90	Mt.		
b.	U.P.S. & COMPUTERISATION				
6	Selector Switch.	1	Job		
7	4 Way TPN DB .	1	Nos.		
8	Circuit Wiring (UPS DB to Computer Points).	60	Mt.		
9	6 Amps. Switch Socket. (3 Socket + 1Switch)	10	Nos.		
10	UPS Protection System (Incoming And Outgoing)				
a.	63Amp.	2	No.		
b.	40 Amp.	2	No.		
c.	AIR CONDITIONING.				
11	Circuit Wiring (1.0/2.0 Ton).	0	Mt.		
12	A/C Box.	0	Nos.		
d.	MAINS & SUB MAINS - Electrical connection				
13	Cable (Main).				
a.	50 mm2 (3.5 CORE)	0	Mt.		
14	Cable (Sub Main)				
a.	25 mm2 (4 CORE)	25	Mt.		
b	10 mm2 (4 CORE)	25	Mt.		
c.	16 mm2 (4CORE)	25	Mt.		
15	Panel (CPRI approved manufactures)	1	Job		
16	TPN Distribution Boards - Horizontal Type. (Including Isolator)				
a.	4 Way.	2	Nos.		
17	SPN Distribution Boards - Horizontal Type. (Including Isolator)				
a.	12 Way.	1	No.		
18	SP MCB.	38	Nos.		
19	DP MCB.	1	Nos.		



20	Earthing Station	2	Jobs		
21	Earthing Wire.	50	Mt.		
e. FIXTURES.					
22	Light - LED (Square Type).				
a.	600 x 600 - 60 Watt.	0	Nos.		
b.	300 x 300 - 30 Watt.	0	Nos.		
c.	150 x 150 - 18 Watt.	0	Nos.		
d.	100 x 100 - 12 Watt.	0	Nos.		
e.	Tube Light (LED) - 18 Watt.	15	Nos.		
f.	Bracket Light (LED) - 7 Watt.	0	Nos.		
23	Wall Mounted Fan.	10	Nos.		
24	Ceiling Fan.				
a.	1200 mm dia.	8	Nos.		
b.	0900 mm dia.	0	No.		
25	Exhaust Fan	1	Nos.		
g. TELEPHONE & LAN POINTS.					
24	Telephone Junction Box.	0	Nos.		
25	Telephone Cable.	0	Mt.		
26	Telephone Points with Wiring.	0	Nos.		
27	Data Cabling with Points	12	Nos.		
28	9U Rack Networking Cabinet	1	Nos.		
29	24 Port Patch Panel	0	Nos.		
30	Patch Chord				
a.	1.0 Mt. Long	10	Nos.		
b.	2.0 Mt. Long	10	Nos.		
31	PVC Conduits For Alarm Etc.				
a.	19mm dia.	0	Mt.		
b.	25mm dia.	0	Mt.		
TOTAL OF ELECTRICAL WORKS (Rs.)					
SAY (Rs.)					
VIVEK SINGH Digitally signed by VIVEK SINGH Date: 2025.07.28 19:03:56 +05'30'					
(Signature of Architect)					



Terms and conditions:-

- A All the materials which are to be used must be of specified brand / quality as narrated above
All the items must be of first quality, no second / commercial material are to be used
having any type of defect.
- B Before installation/ fitting, all the material must be inspected and approved by the Branch
Manager/ Regional Manager/ any Bank official from P&E department, use of defective
/ sub standard / non approved / non specified items will not be accepted under any circumstance
and the entire work will be rejected for such type of discrepancies.
- C The work if ordered is required to be completed in stipulated time, delay will attract penalty
@3.00% every block (each block consist of 5 days).
- D The quoted rates will be valid upto **3 Month**
- E E. The wires to be used of **Havells / Anchor/ Finolex** make and of proper thickness
as stipulated by the Bank.
- F Bank reserves the right to reject one or all quotations without giving any notice, Bank may also
call fresh tenders at a short notice .



**VIVEK
SINGH** Digitally signed
by VIVEK SINGH
Date:
2025.07.28
19:04:09 +05'30'

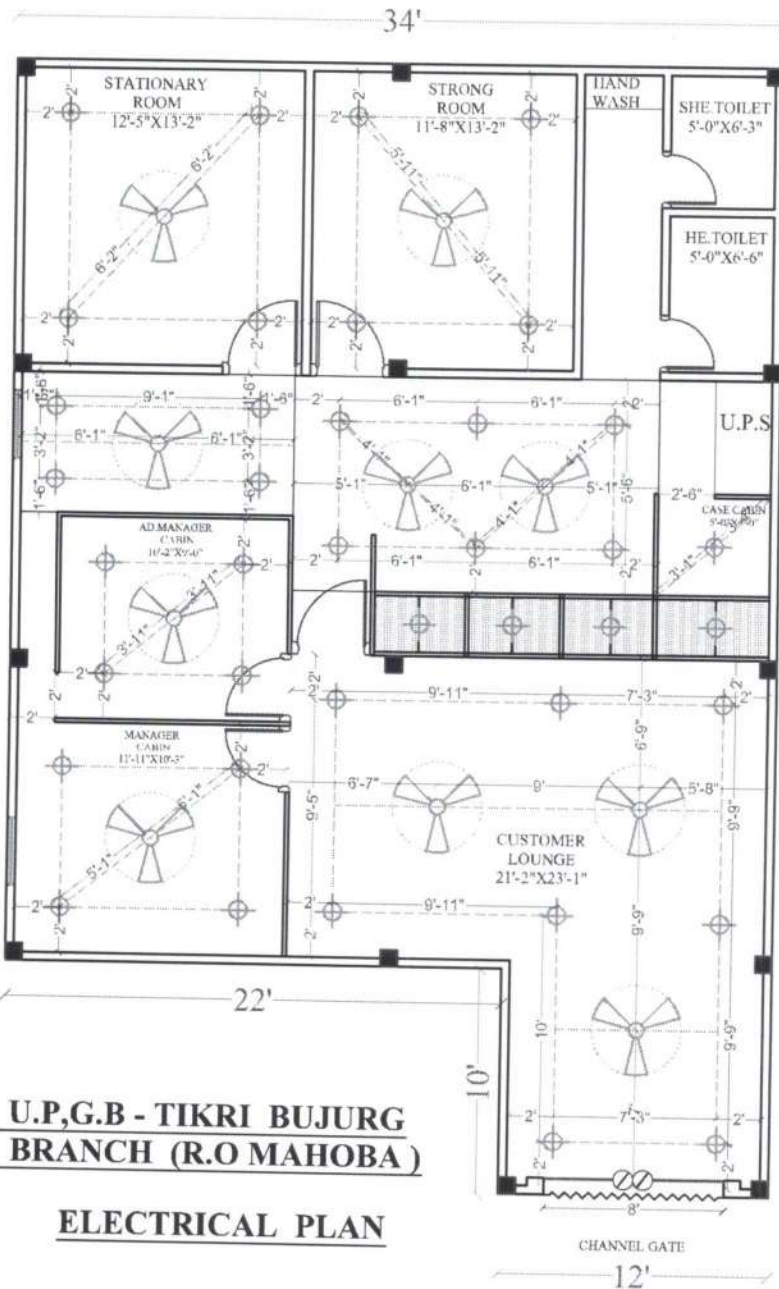

U.P.G.B - TIKRI BUJURG
BRANCH (R.O MAHOBA)

ELECTRICAL PLAN

LEGEND	
	FAN POINT @ CEILING
	GYSER +7'-0" HEIGHT
	16 AMP. A.C. POINT @1'-6" HIGH
	15AMP. POINT @ 4'-0" IN KIT., 6'-0" IN TOI.
	5AMP. POINT @4'-0" IN KIT/ TOILET
	S.B. SWITCH BOARD @ 4'-0" HIGH
	SHOW LAMP @9'-0" HIGH
	BRACKET LIGHT POINT @ 9'-0" HIGH
	CEILING LIGHT POINT
	TELEVISION POINT @4'-0" HIGH
	FOOT LIGHT @1'-0" HIGH
	TUBE LIGHT @ 9'-0" HIGH
	M.C.B. @ 6'-0" HIGH
	GATE LIGHT
	METER BOX @ 6'-0" HIGH
	CALL BELL @ 5'-0" HIGH
	BUZZER @ 9'-0" HIGH
	MIRROR LIGHT @6'-0" HIGH
	EXHAUST FAN
	CH. CHANDELIER

