

उत्तर प्रदेश ग्रामीण बैंक

Uttar Pradesh Gramin Bank

NOTICE INVITING TENDER

Tender for Furnishing Work at Uttar Pradesh Gramin Bank Branch- BHARGAWAN situated At Ground Floor in Vill. Bhargawan, Tah. Sadar, Dist. Shahjahanpur, Pin- 242001.

Sealed tenders on item rate are invited from Empanelled Furnishers of our bank for Furnishing work of Uttar Pradesh Gramin Bank Branch- BHARGAWAN situated At Ground Floor in Vill Bhargawan , Tah. Sadar, Dist. Shahjahanpur, Pin- 242001.

1. Tender documents should be downloaded from Bank's website under Tender section: <https://upgbank.in/tender.php>.

Bidders are requested to visit the Bank's website periodically for any update regarding Tender.

2. Submission of tenders:

a. Your Tender duly filled in and signed and sealed, should be addressed and hand delivered/or delivered through post to The Regional Manager, Uttar Pradesh Gramin Bank, Regional Office, Baduzai-II, Town Hall, Shahjahanpur(U.P.), 242001 on or before 01.08.2025 upto 3:00 PM.

b. The tender to be submitted in sealed envelopes super scribed as "TENDER FOR FURNISHING AND ELECTRICAL WORK AT BHARGAWAN BRANCH" and shall contain the following:

i. Letter for Acceptance of terms & conditions of the tender.

ii. Earnest Money Deposit of Rs. 4000/- (Rupees Four Thousand only) in the form of Demand Draft , FDR in favour of The Regional Manager, Uttar Pradesh Gramin Bank Payable at Shahjahanpur.

iii. bill of quantities duly filled in and signed on each page by the tenderers. No commercial or technical condition shall be indicated by the tenderer in this envelop otherwise the tender shall be liable for rejection.

3. Tenders received late on account of any reason whatsoever and telegraphic tenders will not be entertained.

4. Uttar Pradesh Gramin Bank discourages the stipulation of any condition by the tenderers. The conditional tenders will liable to be rejected.

5. Estimated Cost for Work is approximately Rs. 4 Lacs/- (Excluding GST)

6. Validity of Tender: the tender shall be valid for a period of 90 days, from the last date of submission of the tender.

7. Uttar Pradesh Gramin Bank is not bound to accept the lowest tender and reserves the right to reject any or all the tenders assigning any reason therefore.

8. All The Rates Indicated In The Tender Shall Be Inclusive Of All Material Charges, Transportation, Local Levies As Applicable, Loading, Unloading, Lifting - Shifting, Erection, Testing , Commissioning, etc. As Applicable. GST will be paid extra as applicable.

उत्तर प्रदेश ग्रामीण बैंक

Uttar Pradesh Gramin Bank

9. The Rates Quoted Shall Also Be Inclusive of Local Authorities Permission/ Handling of Municipal / a Local problem is in contractor's scope of work, including obtaining verbal local permissions for smooth functioning the project, Bank shall not pay any extra amount for the same.

10. The contractor should follow the IBA and CPWD guidelines while quoting for tender rates.

11. The Tender will be opened at Uttar Pradesh Gramin Bank, Regional Office-- Shahjahanpur, Baduzai-II, Town Hall, Shahjahanpur(U.P.), 242001 on 01.08.2025 at 03:30 PM.

12. For any clarification contact:

Uttar Pradesh Gramin Bank Regional Office (Shahjahanpur) (Mr. Rajat Kumar Gupta) 8299839405.



Chief Manager
Region: Shahjahanpur



UTTAR PRADESH GRAMIN BANK

TENDER DOCUMENT

FOR

INTERIOR FURNISHING
ELECTRICAL, DATA CABLING WORK FOR BRANCH
BHARGAWAN AT DISTRICT SHAHJAHANPUR

REGIONAL OFFICE: SHAHJAHANPUR
UTTAR PRADESH.

Date of Issue : - 10.07.2025

Date of Submission : - 01.08.2025 Up to 3:00 PM.

ARCHITECTS

M/S MOHIT & ASSOCIATES
L-2/554-, Vineet Khand, Gomti Nagar, Lucknow
Phone.9582218092,7428217659
E-Mail: mohitg.gupta2783@gmail.com

उत्तर प्रदेश ग्रामीण बैंक

Uttar Pradesh Gramin Bank

IMPORTANT SCHEDULES

| | | |
|---------------------------------------|---|--|
| DATE OF ISSUE OF TENDER | : | 10.07.2025 |
| LAST DATE OF RECEIPT OF TENDER | : | 01.08.2025 till 03.00 PM |
| DATE OF OPENING OF TENDER | : | 01.08.2025 at 03.30 PM at RO, Shahjahanpur. |
| EARNEST MONEY | : | Rs. 4000 |
| INITIAL SECURITY DEPOSIT | : | 2.5% of the accepted Value of the Tender, Including Earnest Money. |
| SIGNING OF AGREEMENT | : | Within 2 days of issue of letter of intent/ order |
| COMMENCEMENT OF WORK | : | Within 5 days of issue of letter of intent/ order |
| PERIOD OF COMPLETION | : | 30 days from the date of issue of letter of Intent / order |
| LIQUIDATED DAMAGES | : | RS 5,000 per week, subject to a max. of 7.5% Of the accepted Contract Sum. |
| PERIOD OF RUNNING BILL | : | Fortnightly |
| RETENTION MONEY/DEPOSIT | : | 5 % of Gross Value from Each running Bill |
| REFUND OF SECURITY &RETENTION DEPOSIT | : | a) Initial Security Deposit- to be released within 14 days of requesting the bank after obtaining the certificate of completion. b) Retention Money – to be refunded 14 days after giving in writing a request after End of Defects Liability Period. |
| INCOME TAX DEDUCTION | : | At the Prevailing Rates from each bill |
| DEFECTS LIABILITY PERIOD | : | 12 months after completion of Works |
| PERIOD OF FINAL MEASUREMENT | : | 3 weeks from completion/ date of submission of Final Bill, whichever is later. |

उत्तर प्रदेश ग्रामीण बैंक

Uttar Pradesh Gramin Bank

SECTION – I

INVITATION TO TENDERERS

SECTION- I

1.1 Sealed tenders on item rate basis are invited in the prescribed form by The Regional Manager, Uttar Pradesh Gramin Bank, Regional Office, Baduzai-II, Town Hall, Shahjahanpur(U.P.),242001

1.2

| Tender No. | Name of Work | Earnest Money | Time of Completion |
|-----------------------------|-------------------------------------|---------------|--------------------|
| ROSHAH/PE/2025-26/Tender/02 | Furnishing work at branch Bhargawan | Rs. 4000 | 30 days |

1.3 The work as detailed in this tender shall be executed and completed in all respects within the stipulated period in accordance with the Tender Document, Bill of Quantities, Drawings and Instructions, to the satisfaction of the Architects and the Employers.

1.4 The tenderers is required to deposit for branches- **BHARGAWAN Rs. 4000-** as **Earnest Money** along with the tender in the form of crossed Demand draft payable at **Shahjahanpur**, in favor of The Regional Manager, **Uttar Pradesh Gramin Bank Region Shahjahanpur**. The earnest money will be refunded without any interest to the unsuccessful tenderers.

1.5 Tenders filled in the prescribed form should reach the office of Regional Manager, Uttar Pradesh Gramin Bank, Region Shahjahanpur latest by Date- 01.08.2025, 03.00 PM., in sealed covers and super scribed with the name of the work and the tender No. They would be opened on the same day at 03.30 PM. in the presence of contractor/ Authorized representative with Bank officers.

1.6 Rates must be quoted for complete work at site, inclusive of all costs, taxes, any other charges etc. All charges like Sales tax, Works Contract tax, E.S.I charges etc would be borne by the contractor and Employer will not entertain any claim whatsoever in this respect.

1.7 The tenders shall remain valid for acceptance by the Employer for a period of 3 months from the date of opening the tenders.

1.8 The Security amount and The Retention Money will be refunded without any interest. As per the schedule mentioned.

1.9 The **Defects liability period** will be 12 months from the date of completion of Work. Any defects found during this period in the various jobs executed by the contractor will have to be rectified by him, without any extra charges. Incase the Employer finds that the contractor has not carried out the rectification, then he is at a liberty to get the same executed by another contractor and adjust the amount spend from the Security Deposit of the main contractor.

1.10 The earnest money of the successful tenderers will be forfeited in the event of his refusal/ delay in starting the work. The Decision of **Regional Manager, Uttar Pradesh Gramin Bank Region Shahjahanpur** will be final in this.

1.11 Tender documents (complete) duly filled and signed by the tenderers shall be submitted as the tender for the work.

उत्तर प्रदेश ग्रामीण बैंक

Uttar Pradesh Gramin Bank

- 1.12 The Uttar Pradesh Gramin Bank and the Architects M/s Mohit & Associates, do not bind themselves to accept the lowest or any tender, or to assign any reason thereof and also reserves the right of accepting the whole or part of the tender. The tenderers in such an event will be bound to perform the contract at the same rates as quoted in the tender for various works. Any item is liable for alteration at the discretion of the Architect & the Employer, if required.
- 1.13 Canvassing in any form in connection with the tender is strictly prohibited and the tenders submitted by the contractor who resorts to canvassing in any form will be liable for rejection.
- 1.14 The tendering firms, in case the tenderers is a partnership firm, shall submit the tender signed by all the partners.
- 1.15 On acceptance of the Tender, the Contractor shall intimate the name of his accredited representative who would be responsible for taking instructions from the architects and carrying out the works.
- 1.16 The successful tenderers will extend full co-operation with other contractors appointed by the employer, so that the work shall proceed smoothly. The main responsibility of the overall completion of the work in time will lie with the Furnishing Contractor.
- 1.16 The successful tenderers will need to sign the agreement , three sets, on stamp paper of Rs 100/- only. Tenderers failure to make such an agreement within the stipulated timeframe will amount to non- acceptance on his part. In this case the Employer will have the right to revoke the acceptance of tender without any further notice to the tenderers.

उत्तर प्रदेश ग्रामीण बैंक

Uttar Pradesh Gramin Bank

SECTION – II

INSTRUCTIONS TO TENDERERS

- 2.1 The tenderers are advised to visit and inspect the site at his own cost and responsibility and to secure all necessary information which may be required for completing the tender. Ignorance of site conditions or local information shall not be considered as an excuse for non-performance of the contract or any increase in the rates quoted by him.
- 2.2 The tenderers shall examine carefully all the tender documents consisting of :
- Invitation to Tenderers
 - Instructions to Tenderers
 - General and Special Conditions of Contract
 - Bill of Quantities
 - Set of Drawings
- All the above shall form Part of the agreement.
- 2.3 Time is the essence of contract and the tenderers are required to complete the works in all respects to the satisfaction of the Architect & the Employer within the stipulated time.
- 2.4 The tender should contain the rates & the amount (both in figures and words), in the prescribed column of the BOQ. All the items should be totaled up in the end. All corrections should be duly attested by the tenderers. Incase of any discrepancy between rates and amounts, the lower value will be taken for the finalizing of the tender amount.
- 2.5 It shall be clearly understood that the rates quoted in the tender are to be, for complete work at site, as per the instructions to Tenderers, Conditions of Contracts, Specifications and Drawings and also for all such works as become necessary for proper completion of works, although specific mention thereof may not have been made in the specifications or drawings of tender documents. The rates shall be firm and not subject to cost escalation on account of labour and material conditions or any other reason whatsoever.
- 2.6 The tenderers shall use only the form issued with this tender to fill up the rates.
- 2.7 Every page of the tender shall be signed on the left hand side bottom corner.
- 2.8 The Contract will be governed by the Indian Contract Act, Indian Sale of Goods Act and all other relevant Laws. All payments due to the contractor under the contract will be made in Indian Rupees Currency.

उत्तर प्रदेश ग्रामीण बैंक

Uttar Pradesh Gramin Bank

SECTION III - FORWARDING LETTER

FROM -----

TO, The Regional Manager
Uttar Pradesh Gramin Bank
Regional Office
Shahjahanpur,

Ref: Tender No. ROSHAH/PE/2025-26/Tender/02

Dear Sir,

With reference to the tender invited by you, I/we hereby offer to perform, provide, execute and complete the works in conformity with conditions of contract, drawings and specifications for the respective items of schedule of quantities attached hereto.

I/we have satisfied ourselves as to the location and prevailing conditions of the site, and have read carefully the Articles of Agreement, Conditions of Contract, Specifications, General and Special Conditions, Technical Specifications, etc. I/we understand that the works are to be completed within ----days from the date of issue of letter of Intent/ Order and fully understand that time will be the essence of the contract.

I/ we enclose a demand draft for branch at, BHARGAWAN Rs.4000, drawn on The Regional Manager, Uttar Pradesh Gramin Bank, payable at Shahjahanpur, in favor of Uttar Pradesh Gramin Bank as Earnest Money and fully understand that this amount will not bear any interest.

I/we agree to keep the offer open for 90 days from the date of opening the tender.

Should this tender be accepted in whole or part, I/we hereby agree to abide by and fulfill all the terms and conditions annexed hereto.

All the terms and conditions of tender have been fully read by me/us. I/we accept the same and sign hereunder in token of their acceptance.

We further enclose the following documents:-

- i) Partnership deed, Article of Association and Power of Attorney, as applicable. We agree that no change will be made in these documents without prior approval of Uttar Pradesh Gramin Bank
- ii) Tender document Duly signed.
- iii) Details of my firm
- iv) Latest ITCC

Name of Partners/ Directors

Yours Faithfully

Date

Signature of Tenderers with
Official Stamp

उत्तर प्रदेश ग्रामीण बैंक

Uttar Pradesh Gramin Bank

SECTION –IV

GENERAL CONDITIONS OF CONTRACT

DEFINATIONS

In this contract, the following words and expression shall have the meaning thereby assigned to them unless the contract ascribed a different meaning

- a) **Employer** means Uttar Pradesh Gramin Bank and includes their authorized representatives to deal with any matter on their behalf.
- b) **Employer- in – charge** means the person appointed by the Employer and notified to the Contractor to be in charge of the project
- c) **Clerk of Works** means any Engineer appointed by the Employer to perform the duties of Resident Engineer, limited to Supervision of Work and notified to the Contractor to be in charge of the project
- d) **Architects** means the Architects Employed by Uttar Pradesh Gramin Bank to give consultancy.
- a) **Contractor** means the individual, firm or Company with whom the contract is entered into and includes the heirs, executors, or successors.
- b) The expression **Contract** means the document forming the Tender and acceptance thereof and included all the sections of the tender including BOQ and set of drawings.
- c) **Tender** means the offer made by an individual or firm or company for execution of the works.
- d) **Acceptance of Tender** means the letter from the Employer communicating to the tenderer the acceptance of this tender and include the advance acceptance of his tender.
- e) **Drawings** means the drawings referred to in the tender documents including any modifications of such drawings approved in writing by the Architect or his representative and such other drawings as are made from time to time and furnished by the contractor and approved by the Architect.
- f) **Site** means the actual place as described in the tender at which the execution of works is to be done with the surrounding areas.
- g) **A Week** shall mean 7 days without regard to the number of Hrs worked in a day in that week.
- h) **Specifications** means standard specifications for works and materials brought out in the tender, and added to or superseded by special specifications. In absence of any

उत्तर प्रदेश ग्रामीण बैंक

Uttar Pradesh Gramin Bank

specifications for any item of work the relevant specifications in CPWD or IBA works Manual shall be followed and work be executed accordingly.

4.2.1 EXTENT OF CONTRACT

The contractor shall supply at his own cost all the materials like ladders, scaffoldings, temporary works that may be required for the proper execution of the works, whether original, altered or substituted works. The contractor shall also supply survey instruments and other materials necessary for purpose of setting out of works and assisting to the measurements or examination at any time.

The contractor shall also provide a sufficient portion of fencing and lights required to protect the public from accidents and shall be bound to bear any expenses of defense brought by any person for injury sustained owing to neglect of the above precautions, and to pay any damages and costs which may be awarded in any such suit, action or proceedings to any such person. In no case the Employer shall be a party to any such claim and the Contractor shall indemnify the Employer against any claim for any person on this account.

4.2.2 Sufficiency of Tender

The Contractor shall be deemed to have satisfied himself before tendering as to the correctness and sufficiency of his tender for the works and his prices for the work which shall cover all his obligations under the Contract and all matters and things necessary for the proper completion and maintenance of the work.

4.2.3 Sub- Letting of Contract

The contractor shall not assign the contract or any part thereof to any other party without the prior written consent of the Employer.

4.2.4 Power to Make alterations

Architect shall have the powers to make any alterations or additions to the stipulated specifications, drawings, designs and instructions that he may feel necessary or advisable during the progress of the work. The contractor shall have no claim for compensation on account of such alterations or additions. The contractor shall be bound to carry out the work in accordance with any instructions which may be given to him in writing signed by the Architect and such alterations shall not invalidate the Contract, and any additional work which the Contractor may be directed to do in the manner above specified as part of the work shall be carried out by the contractor.

The time for completion and Costs of such additional works shall be extended in proportion to the original contract. The certificate of the Architect shall be conclusive as to such proportions.

4.2.5 Works subject to approval of Architect

All works to be executed under the contract shall be subject to approval of the Architect who shall be entitled to direct at what points and in what manner they are to be commenced.

उत्तर प्रदेश ग्रामीण बैंक

Uttar Pradesh Gramin Bank

4.2.6 Urgent repairs and Urgent Works

If by any reason, during the execution of the work or during the defects liability period, any works or repair become urgently necessary and the Contractor is unable / unwilling to do such work immediately, then the Employer may get the same done on their own and deduct the cost thus incurred from the funds due to the contractor.

4.2.7 Clearance of Site

The Contractor shall have to remove all Malbaa from site of work, dirt and dust, etc. before handing over the works to the Employer. The works shall not be treated as complete in all respects unless these requirements are fulfilled.

In the event the Contractor failing to do so the architect and the employer shall have the right to get the site cleared at the contractors risk and cost.

4.2.8 Protection of Trees and Shrubs

Trees and Shrubs designated by the Architect shall be protected from damage during course of the work and the earth level shall not be changed within three feet of such trees.

4.3 ARCHITECTS STATUS AND DECISIONS

- a) The Architect shall have General supervision & direction of Works. He has authority on behalf of the Employer to stop the work whenever such stoppage may be necessary to ensure proper execution of the works. The Architect shall be the interpreter of the conditions of Contract and the judge of its performance.
- b) The Architect within reasonable time make decisions of all claims of the contractor and all other matters related to the execution and progress of work.

The decision of the Architect with respect to all or any of the following matters shall be final

- i) Variation/ Modification of the Design
 - ii) Quality and Quantities of Works Executed
 - iii) Discrepancies in the drawings and Specifications
 - iv) Opening up for inspection of any work covered up.
 - v) Amending of any defects occurring under Defects Liability Period
- c) The Contractor shall on the report of the Architect immediately dismiss from the works within 24 hrs any person employed thereof by him who may in the opinion of the Architect/ Employer be incompetent/ misconducts himself.

4.4 DIRECTIONS REGARDING DRAWINGS & DESIGN

- a) After signing the Contract, the Contractor will be given three sets of drawings free of charge. Additional copies if required would be made at his own costs. One set of the

उत्तर प्रदेश ग्रामीण बैंक

Uttar Pradesh Gramin Bank

drawings shall be kept at the site by the contractor and available to Architect/ his representative at all times.

- b) Further drawings and Instructions including revisions, as the Architect may furnish to the contractor shall form part of this contract.
- c) Only figured dimensions and detailed drawings shall be followed. The Contractor shall verify all dimensions in the field before any work is Commenced and obtain instructions of the Architect incase of any discrepancy.

4.4.2 Action where no specifications

In case of any work for which there are no specifications in the contract, such works shall be carried out in accordance with the directions of the Architect.

4.5 DIRECTIONS FOR EXECUTION OFWORKS

4.5.1 Setting Out

The Contractor shall be responsible for the true and proper setting out of works. If at any time during the progress of the work any error shall appear in any part of the work, the Contractor shall rectify the errors. The checking of any setting out by the Employer/ Architect shall not in any way relieve the contractor of his responsibility for the correctness thereof.

4.5.2 Engagement of labour

The Contractor shall employ labour in sufficient numbers to maintain the required rate of progress and Quality of work. No child labour will be employed by the Contractor.

The contractor shall comply with all the provisions of Minimum wages Acts, Industrial Disputes Acts, ESI Acts.

The Contractor shall indemnify the Employer against any payment to be made under And for observance of the Regulations aforesaid without prejudice to his right to claim Indemnity from his sub- contractors.

The contractor shall provide at his own cost for the protection of the works and for the Safety of those employed on works or the Public.

4.5.3 Water and Power Requirements

All arrangements for water and Power required shall be made by the Contractor at his own costs and nothing extra on this account shall be paid to him. Similarly filtered water required for drinking purposes for the labourers shall also be arranged by the Contractor at his own cost.

The contractor shall make necessary arrangements for procuring petrol/ diesel for machinery or for Power generation to ensure uniform progress of work in the event of Power failure.

No extension of time of completion of the contract shall be allowed on account of Power failure.

उत्तर प्रदेश ग्रामीण बैंक

Uttar Pradesh Gramin Bank

4.5.4 Disruption of Progress

The Contractor shall give written notice to the Architect whenever progress of work likely to be delayed. The notice shall include details of the drawings or order required and of why and when it is required and of any delay likely to be suffered if it is late.

If for any reason, within reasonable time, the Architect is unable to give directions, and the work suffers, then the Architect shall take such delay into account in determining any extension of time to which the Contractor is entitled.

4.5.5 Rectification of Defects

If it appears to the Architect that any work has been executed with imperfect workmanship or inferior material, then the Contractor shall rectify/ reconstruct the part so specified.

4.5.6 Samples

Samples of all materials to be used in works, shall be submitted for approval to the Architects, within four days of commencement of Contract.

The costs for preparing samples will be borne by the contractor.

4.5.7 Inspection Of Works

All works in execution stage or executed shall be open to inspection and supervision of the Architect/ his representatives. During the Visit of the Architect, the Contractor or his representative should be available on site.

4.5.8 Preparation of Program Schedule

The contractor, in consultation with the Architect shall prepare a program schedule of the various activities, before commencing of the works.

4.5.9 Extension of Time for Completion

If the contractor shall desire an extension of the time for completion of the work, on his having been unavoidably hindered in its execution or on any other ground, he shall apply in writing to the Architect within 3 days of occurrence of such hindrance and the extension he so desires.

The Architect, in consultation with the Employer shall, if, in his opinion will authorize such extension of time as may be proper.

4.5.10 Liquidated Damages For Delay

The time and Date stipulated in the contract for the completion of the work shall be deemed to be the essence of the contract. If the contractor fails to carry out the works within the stipulated time or the extended time if given, then he shall pay to **UTTAR PRADESH GRAMIN BANK** a sum of Rs 5,000/- per week as Liquidated damages, for the period the

उत्तर प्रदेश ग्रामीण बैंक

Uttar Pradesh Gramin Bank

works remain unfinished. The total amount of such a penalty shall not exceed 7.5% of the total Contract Price.

4.5.11 Defects Liability Period

The Contractor shall be responsible to make good and remedy at his own expense within such period as may be stipulated by the Employer any defects which may develop or may be noticed before the end of 12 months from the Certified Completion date and intimation of which has been send to the contractor within 7 days of the expiry of the said period.

If the Contractor, while rectifying the above defects, damages any other area of the site, will make good the related defects also at his own expense. In case he does not do so then the same would be got done by the Employer and expenses would be deducted from the amount due to the contractor.

4.6 MEASUREMENTS AND PAYMENTS

- 4.6.1 A bill supported with measurement details shall be submitted by the contractor Fortnightly to the Architect for all works executed and the Architect or his Representative shall verify the requisite measurements. All bills shall be submitted in Triplicates.

All such intermediate payments to the contractor shall be regarded as payments by way of advance against the final payment and not as payments for works actually done and completed and shall not preclude the requiring of bad and imperfect work to be rectified or considered as an admission of due performance of the contract.

Income tax deductions will be made as per the prevailing rates from the contractor's on account bills.

4.6.2 Final Bill

Final bill supported with consolidated measurements of the full work executed shall be submitted by the contractor, the same will be verified by the Architect within Three weeks of Completion of Works.

After Verification, the Architect will give seven days notice to the Contractor to Countersign the bill as a token of acceptance or intimate in writing his intention to dispute. If the Contractor fails to take appropriate action within the prescribed period as above, then the bill finalized by the Architect shall be final and binding on the Contractor.

4.6.3 Claim for Interest

No Claim for interest will be entertained by the Employer, with respect to any money balances as lying with the Employer.

4.6.4 Rates For Extra, Additional, Altered or Substituted works.

उत्तर प्रदेश ग्रामीण बैंक

Uttar Pradesh Gramin Bank

The rates for additional, altered or substituted work shall be worked out in accordance with the following provisions, in their respective order.

- i) If rates for similar works are directly available in the Contract for the work, the contractor is bound to carry out at the same rates as available in the contract.
- ii) If rates are not directly available in the contract, then they will be derived from the rates for a similar class of works as are specified in the contract.
- iii) If the rates cannot be determined, then the Contractor shall submit a detailed cost analysis as per market rates for same. The Architect will settle such claims.

4.7 GUARANTEES

4.7.1 **Quality Of Work**

The Contractor shall guarantee that the materials and workmanship are the best of their respective kinds for the service intended and that all items of work will be free from all inherent defects in workmanship and materials. He shall also guarantee that the works will not fail in any respect due to quality of materials, workmanship and method of construction.

The Specifications assume a proper degree of Skill on the part of the Contractor and Workmen Employed. The Contractor shall consult the Architect, whenever in his judgment variation in the methods of Construction or in the quality of material would be beneficial or necessary to fulfill the guarantee called for. Such variations may be made by the Contractor, only when authorized by the Architect.

4.7.2 **Cost of Execution of work or repair, etc.**

All works of repair shall be carried out by the contractor at his own expense if the necessity thereof shall in the opinion of the Architect be due to the use of materials or workmanship not in accordance with the contract or on account of neglect or failure on the part of the contractor to comply with any obligation expressed or implied on the contractor's part under the contract.

4.7.3 **Remedy on Contractor's failure to carry out the works required.**

If the contractor shall fail to do any such work as the aforesaid required by the Architect. The Employer shall be entitled to carry out such works at the contractor's own cost and recover the same from any money that may become due to the contractor.

4.7.4 **Contract Valid during Guarantee Period**

This contract shall remain valid and in force until the expiry of Guarantee Period.

4.8 RESCINDING/ TERMINATE CONTRACT

- 4.8.1 In any case under any clause of this contract, the contractor has rendered himself liable to pay compensation amounting to whole of his retention deposit in hands of Employer, the Architect in consultation with the Employer, on his behalf shall have power to adopt any of the following courses-

उत्तर प्रदेश ग्रामीण बैंक

Uttar Pradesh Gramin Bank

- a) To rescind the contract (of which rescission notice in writing to the contractor shall be conclusive evidence)
- b) To employ a contractor paid by the Employer and to supply materials to carry out the work or any part of the work, debiting the contractor with the cost of the labour and the price of the materials.
- c) To measure up the work of the contractor and to take such part of the work of the contractor as shall be unexecuted out of his hands and to give it to another contractor to complete. In this case any expense which may incur in excess of the sum which would have been paid to the original contractor, if the whole work had been executed by him, shall be borne and paid by the original contractor and may be deducted from any money due to him by the Employer.

In the event of any of the above courses being adopted by the Architect, the Contractor will have no claim to compensation to any loss sustained by him.

4.8.2 Termination Of the Contract

If at any time after the commencement of the work the Employer for any reason whatsoever not require the whole or part thereof as specified in the tender to be carried out, Architect shall give notice in writing of the fact to the Contractor who shall have no claim to any payment or compensation whatsoever on account of any profit or advantage which would have derived from the execution of the work.

4.8.3 Jurisdiction

The contract and its operation shall be governed by the laws of India, for the time being in force. The contract shall deemed to have been entered into at R.O Shahjahanpur.

4.8.4 Bye Laws and Local Authorities

The contractor shall conform to the provisions of any Govt. Acts and regulations of Local Authorities. Contractor would pay all charges and fees for towards Stacking, etc. The Contractor shall keep the Employer indemnified against all penalties and liabilities incurred in connection with the said contract.

The contract will be governed by the Indian Contract Act, Indian Sales Act and all other relevant laws.

4.8.5 Arbitration

All disputes related to the said contract shall be referred to the arbitration of the person appointed by the Employer. All rules will be subject to Arbitration Act 1940, or any statutory modification or re- enactment thereof.

उत्तर प्रदेश ग्रामीण बैंक

Uttar Pradesh Gramin Bank

It is a term of the contract that if the Contractor does not make any demand for arbitration in writing within 30 days of receiving the intimation from the Employer that bill has been certified for Payment, the claim of the contractor will deemed to have been waived absolutely bared and the Employer shall be discharged and released of all liabilities under the contract.

उत्तर प्रदेश ग्रामीण बैंक

Uttar Pradesh Gramin Bank

SECTION –V

FORM OF AGREEMENT

Made at... day of..... between **Uttar Pradesh Gramin Bank**, Regional Office, **Shahjahanpur** (hereinafter referred to as the Employer which expression shall include their heirs, executors, administrators and assigns) of the one part and (hereinafter referred to as Executors which expression shall include their heirs, executors, administrators and assigns) of the other part.

Employer is desirous **of furnishing Works for branches at Branch Bhargawan, R.O- Shahjahanpur**

has caused drawings and specifications describing the work to be done to be prepared by **M/s Mohit & Associates** as their Architects.(hereinafter referred to as the Architects)

The said drawings and Specifications and the Price Schedule of Quantities have been signed by both the parties and the contractor has agreed to execute upon.

NOW IT IS HEREBY AGREED AS FOLLOWS

1. In consideration of the said contract, payments to be made to the contractor as hereinafter provided he shall upon and subject to the said conditions execute and complete the works shown upon the said drawings and such further detailed drawings as may be furnished to him by the said Architects and described in the specifications and the said Priced Schedule of Quantities.
2. The Employer shall pay the Contractor such sums as shall become payable hereunder at the times and in the manner specified in the said conditions.
3. The said Contract comprises the building above mentioned and all subsidiary works connected there within the same site as may be ordered to be done from time to time by the said Architects even, though such works may not be shown on the Drawings or described in the said Specifications or the Priced Schedule of Quantities.
4. The Employer through the Architect reserves to himself the right of altering the drawings and nature of the work and adding to or omitting any items of work or of having portions of the same carried out otherwise and such alterations shall be carried out without prejudice to this contract.
5. The Employer in consultation with the Architect reserves the right to exercise control on quality of work, check the measurements, approval of rates of extra or substituted items. The decision of the Architect shall be final and binding in this regard.
6. The following documents shall be deemed to form and construed as part of this agreement along with the amendments, negotiated and confirmed in various subsequent letters exchanged as mentioned hereinafter and parties hereto will respectively abide by and submit themselves to the Conditions and Stipulations and perform the agreement on their parts respectively in such conditions contained

उत्तर प्रदेश ग्रामीण बैंक

Uttar Pradesh Gramin Bank

- a) Notice inviting Tender
 - b) Instructions to Tenderers
 - c) General Conditions of Contract
 - d) Special Conditions of Contract
 - e) Technical Specifications
 - f) Schedule of Quantities
 - g) Employers letter dated..... To the Contractor awarding the Contractor awarding the Contract
 - h) Contractors letter dated to the Employer in acceptance of the award of Contract
7. All dispute arising out of or in anyway connected with the agreement shall be deemed to have arisen at **Shahjahanpur**, the Court in **Shahjahanpur** shall have jurisdiction to determine the same.
8. The several parts of this contract have been read to us and fully understood by us.

Witness our hand this day of**2024**

SIGNED BY THE SAID EMPLOYER

Witness

1)

2)

SIGNED BY THE SAID CONTRACTOR

Witness

1)

2)

उत्तर प्रदेश ग्रामीण बैंक

Uttar Pradesh Gramin Bank

SECTION –VI SPECIAL CONDITIONS OF CONTRACT

6.1 **Insurance for Works**

The contractor before commencing on execution, without limiting his obligation shall insure the works against all acts of God, at his own costs and keep them insured till the completion of the project, in the joint names of the Employer and the contractor, for the full amount of the Contract.

The Contractor shall deposit the policy and receipt for the premiums with the Employer within 7 days from the date of signing of the contract. Incase the Contractor fails to do so, then the Employer can make the required Policy and deduct the amount from the Contractors amount due.

6.2 **Insurance in respect to damage to persons and property**

The contractor shall be responsible for all injury to persons, animals or things and for all structural and decorative damage to property which may arise from the operation or neglect of himself or any other person employed by him.

The clause shall be held to include any damage to buildings whether immediately adjacent or otherwise. The Contractor shall indemnify the Employer and hold him harmless in respect of all and any expenses arising from any such injury or damage to persons or property.

The Contractor shall reinstate all damages of every sort mentioned, due to his contract work to the property of third parties.

The Employer shall be at liberty and is empowered to deduct the amount of any damage or compensation levied on him due to the negligence of the Contractor.

Such insurance will not limit or bar the liability and obligation of the contractor to deliver the works to the Employer complete in all respects as per the contract. Incase of loss or damage, the money payable under any insurance shall be received and retained by the Employer until the works are finally complete and such money shall then be credited to the Contractor in final settlement of accounts.

SECTION – VIII

उत्तर प्रदेश ग्रामीण बैंक

Uttar Pradesh Gramin Bank

LIST OF APPROVED AND NOMINATED MANUFACTURERS / SUPPLIERS OF MATERIALS FOR BARODA GRAMIN BANK AT SHAHJAHANPUR, UTTAR PRADESH.

| S.NO. | MATERIALS | APPROVED BRANDS |
|-------|--|--|
| 1 | False Ceiling & Cornices | India Gypsum |
| 2 | AluminiumFram | Jindal,Indal |
| 2 | Wood Framework: All wood must be well seasoned, free from knots, other defects. | Meranti (seasoned) with two coats of wood preservative |
| 3 | Wood skirting /mouldings, Lipping /beading | Steam beech/ Mahogany/ Teak wood |
| 4 | BWP Marin Ply wood(IS: 710) | Green ply/Archid/Century |
| 5 | Laminate | Century/Archid/Greenlam/Sunmica |
| 6 | Veneer | Century/Archid/Greenlam |
| 7 | Wood Preservative | STP- Pentaphene pale / Termination Tor(Pidilite) |
| 8 | Adhesive | Fevicol SH (Pidilite) / Araldite/SR- 998/Century – SH |
| 9 | Door Closer | Dorset/ ozone/opel |
| 10 | Floor Spring | Dorma/ozone |
| 11 | Door Lock | Ozone /Dorset/golden/Godrej |
| 12 | Drawer Lock | Ozone /Dorset/golden /Godrej |
| 13 | Hardware | GKW |
| 14 | Hinges | Ozone /CIEF/Ebco |
| 15 | Screws | GKW/ Nettle fold |
| 16 | Carpet | Interface/ Shaw |
| 17 | Vertical blinds | MAC decor/Vista levolor |
| 18 | Sun Control Film | 3M or equivalent |
| 19 | Soft Board / Display Board | Jolly board |
| 20 | Paints | Berger/ Asian/ Nerolac |
| 21 | Texture paint | Spectrum/ Oikos |
| 22 | Ceramic Tiles | Orientalbell ,Nitco, , Kajiria |
| 23 | Vitrified tiles | Orientalbell ,Nitco, , Kajiria |
| 24 | Glass & Mirror | Modi Guard/ Saint gobain, Ashai |
| 25 | Handle | Stainless steel finish Neki / Hassely/ Hattich |
| 26 | MDF Boards | Greenpanel max/ Archid/Merino |
| 27 | Wooden flooring | Green panel max, Archid, Pergo |
| 28 | PVC flooring | Armstrong/ Krishna vinyl |
| 29 | Sanitary fittings | Toto/ Roca/ Kohler/ Grohe / Jaquar |
| 30 | | AFC/Monarch/PSL/SPACEWOOD/STEELCASE |

उत्तर प्रदेश ग्रामीण बैंक

Uttar Pradesh Gramin Bank

The above material list is only indicative and equivalent material may be used. Prior Approval from Bank / Architect to be obtained for any material to be used at site.

NOTE:-

- 1. In case of unavailability of any material of specific make an equivalent make can be used only after a written approval of the Architect / Bank. The preference of make/brand of the material listed above will be decided by the Architect/ Bank. The make/brand of any item will be as mentioned in the drawings issued by the Architect.**
- 2. The contractor shall provide samples of all materials mentioned in the list of makes as required by the Architect. A written approval of these samples shall be sought prior to commencement of any work. Architect / Bank reserves the right to enquire the genuineness of any material used at site directly from the manufacturer/dealer.**

उत्तर प्रदेश ग्रामीण बैंक

Uttar Pradesh Gramin Bank

LIST OF APPROVED AND NOMINATED MANUFACTURERS / SUPPLIERS OF MATERIALS FOR BARODA GRAMIN BANK AT SHAHJAHANPUR.

| S.NO. | MATERIALS | APPROVED BRANDS |
|-------|------------------------------------|-------------------------------------|
| 1 | PVC fittings | Polycab/ AKG / Precision |
| 2 | Wires – PVC insulated copper | Finolex/ Rallison/Polycab/Skytone |
| 3 | Cables (armored) | Gloster / Rallison / Havells |
| 4 | A.C Starter, Plug Socket | Crabtree / Northwest/ Legrand |
| 5 | Light & Power switch socket | Crabtree / Northwest /Philips |
| 6 | Telephone Socket | RJ-11 Crabtree/ Philips/MK |
| 7 | DB MCB | Legrand/ Hager/ Standard/ Schneider |
| 8 | MCB | Legrand/ Havells/ Hager/ Schneider |
| 9 | Telephone cable | 0.51 Netco / Delton / National |
| 10 | Light fitting | PHILIPS/Wipro/Havells |
| 11 | Fuse Switch | L&T / Havell's |
| 12 | Telephone Connector | Corn |
| 13 | Ceiling/ Wall fan | Crompton / Orient / Khaitan |
| 14 | Exhaust fan | Crompton / Orient / Khaitan |
| 15 | P.V.C tape | Steel Greep |
| 16 | Call bell | Max |
| 17 | Cable Lug | Dowell's |
| 18 | Cable gland | Brass heavy type good quality |
| 19 | Distribution board | L&T/ Havells,legrand |
| 20 | MS conduit | Heavy duty with ISI mark 16 SWG |
| 21 | Starter & single phasing preventer | SEIMENS |
| 22 | SPN, TPN, Sheet metal | Havell's / Legrand |
| 23 | Pipe Metal | M.S Conduit 16 S.W.G |

उत्तर प्रदेश ग्रामीण बैंक

Uttar Pradesh Gramin Bank

| | | |
|----|------------------------------|---|
| 24 | Metal Pipe Fittings | Cast iron with thread & inspection cover |
| 25 | Pipe PVC (Rigid Conduit) | AKG / Polypack/Super/Precision |
| 26 | PVC fitting for Rigid | -Do- |
| 27 | PVC Roll Pipe | Super Dalda or equivalent heavy guage |
| 28 | PVC Casing & Casing Fittings | Good quality heavy guage (colour white) |
| 29 | Lugs | Dowells |
| 30 | Terminals | Essen/Elmex |
| 31 | Burglar alarm | Godrej/ Globe detective |
| 32 | E-cat 6 Patch panel | Schneider Electric/ Avaya |
| 33 | P.A. System | Bosch/ Ahuja |
| 34 | CCTV camera | Sony/ Bosch |
| 35 | CCTV camera wiring | Crompton/ KEI |
| 36 | UPS wiring | Crompton/KEI |
| 37 | Aluminum ducting sheet | Jindal/ SAIL |
| 38 | AC | Blue Star/ Hitachi/ Daikin Only Copper Coil (Minimum 3 Star rated) |
| 39 | | |

NOTE:-

1. In case of unavailability of any material of specific make an equivalent make can be used only after a written approval of the Architect. The preference of make/brand of the material listed above will be decided by the Architect. The make/brand of any item will be as mentioned in the drawings issued by the Architect.

2. The contractor shall provide samples of all materials mentioned in the list of makes as required by the Architect. A written approval of these samples shall be sought prior to commencement of any work. Architect reserve the right to enquire the genuineness of any material used at site directly from the manufacturer/dealer.

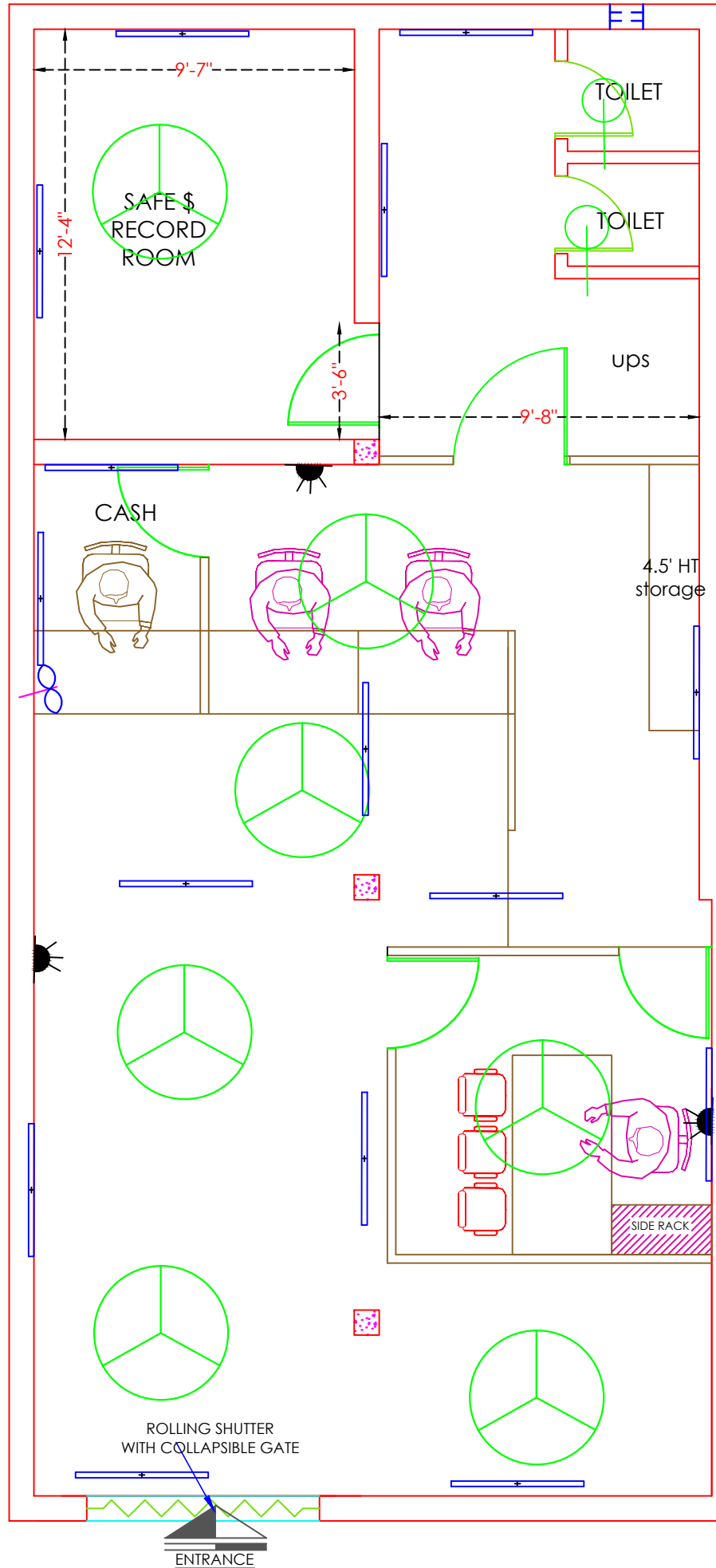

PROJECT
 PROPOSED FURNISHING LAYOUT OF UP GRAMIN BANK BRANCH AT
 BHARGAWAN- DISTRICT SHAJAHANPUR

DRAWING
**ELECTRICAL
 LAYOUT**

NORTH

SCALE
 N.T.S.
 DATE
 JULY 2025

ARCHITECT
MOHIT & ASSOCIATES
 ARCHITECTS, INTERIORS, ESTIMATORS
 L-2/554 VINEET KHAND, GOMTI NAGAR,
 LUCKNOW - MD. - 07428217459/9582218992

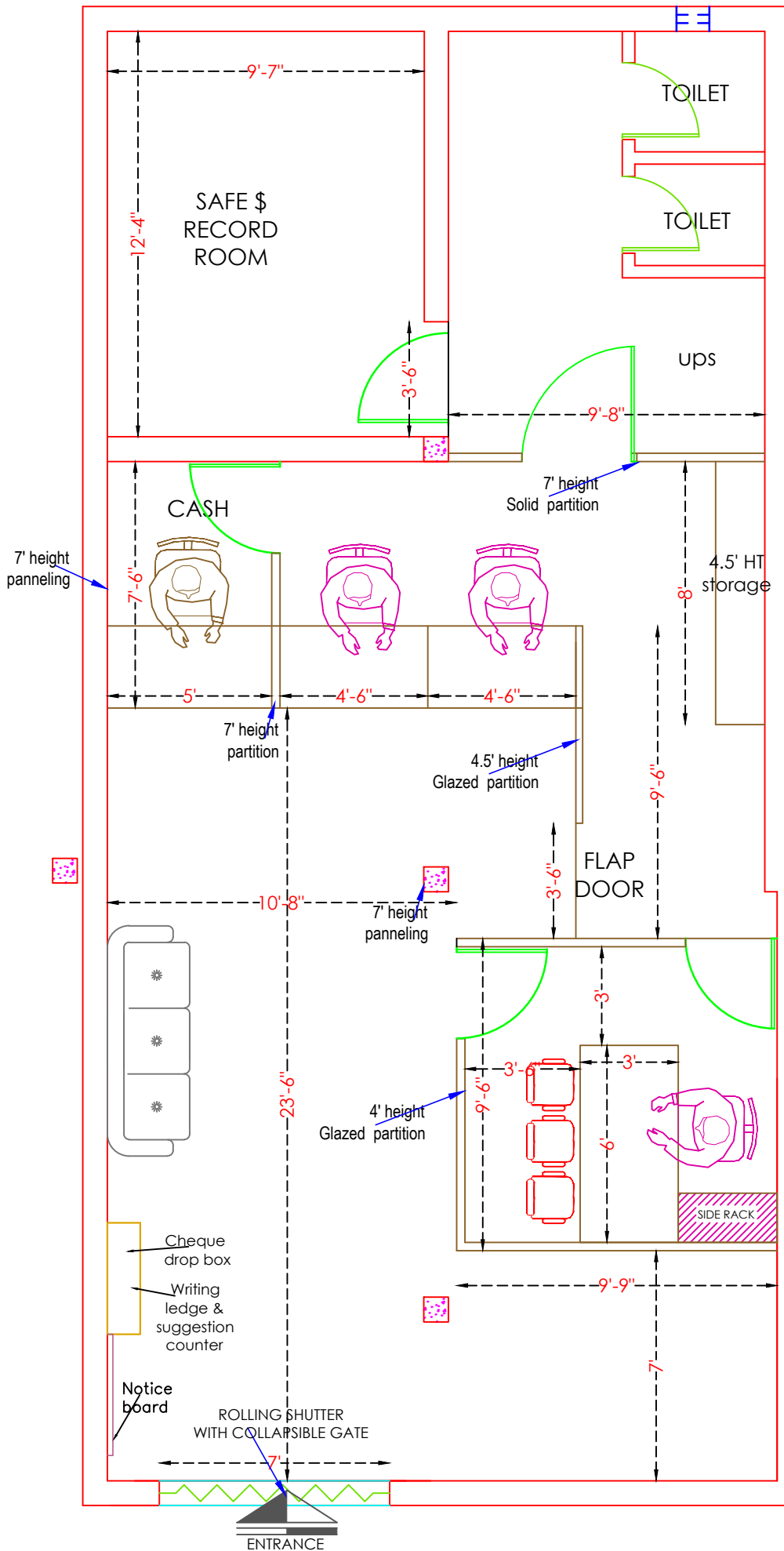

| | | |
|---|---|------------------|
| | <p style="text-align: right;">Mohit & Associates. Architects, Interiors .Estimators L-2/554-, Vineet Khand, Gomti Nagar, Lucknow. Phone.9582218092,7428217659 E-Mail: mohitg.gupta2783@gmail.com</p> | |
| | | |
| <p style="text-align: center;">SUMMARY FOR INTERIOR REFURNISHING WORK FOR BARODA UP BANK BRANCH AT BHARGAWAN- DISTRICT SHAJAHANPUR(UP)</p> | | |
| | | |
| S.NO | DESCRIPTION | AMT (Rs.) |
| | | |
| A | SCHEDULE - 'A' (FURNISHING WORK) | |
| | | |
| B | SCHEDULE - 'B' (ELECTRICAL WORK) | |
| | | |
| C | SCHEDULE - 'C' (DATA CABLING) | |
| | | |
| | TOTAL SCHEDULE A+B +C= | |
| | | |
| | | |
| | IF ANY DISCOUNT | |
| | | |
| | DISCOUNT AMOUNT | |
| | | |
| | GRAND TOTAL | |
| | | |
| | NOTE :- GST (WCT) TAX WILL BE EXTRA. | |
| | | |
| | Contractor Signature & Seal | |
| | | |
| GST No:- | | |

| B.O.Q OF REFURNISHING WORK FOR UTTAR PRADESH GRAMIN BANK BRANCH AT BHARGAWAN-DISTRICT-SHAJAHANPUR(UP) | | | | | |
|---|---|--------|--------|------|-----|
| A | SCHEDULE - 'A' (FURNISHING WORK) | | | | |
| S.NO. | DESCRIPTION | UNIT | QTY. | RATE | AMT |
| 1 | PARTITIONS WORK | | | | |
| 1.1 | FULL / LOW HEIGHT SOLID PARTITION / DOOR /UPS | Sq.Ft. | 70.00 | | |
| | Full ht. Solid Partition up to ceiling only WITH LOUVRE :- Providing and fixing solid partition , the framing shall made out of aluminium hollow section of 65mm x 37mm size 1.5mm thick of JINDAL / INDAL as internal frame structure placed horizontally & vertically at max distance of 2'-0" x 2'-0" center to center. Fixing 6 mm thick commercial ply on both sides with 1.0mm thick laminate on top of approved shade with groove pattern as per instructions of Architect. The rate shall include the cost of providing skirting of 100mm wide lined with 1mm thk laminate and providing & fixing a border at top of 100mm wide lined with 1mm thk laminate complete. Laminate Should be considered up to two or three color combination. The edge beadings with steam beach wood should be finished with melamine polish if required, frame work above false ceiling done shall not be measured but contractor may factor it while quoting there rates as measurment up to false ceiling lvl.. | | | | |
| | The rate inclusive of providing & fixing of required flush door of 37mm thick approx. with 1.0mm th.laminate both side with steem beech wood chowkhat of size 75mm x 65mm approx and Item includes Heavy-duty SS ball bearing butt hinges 100 x 5.5 mm (4 Nos. per shutter) with screws etc.The shade of laminate finish to be got approved from Bank. . All as per the design and instructions Bank. | | | | |
| | Note :- For the purpose of payment partition shall be measured including the area of door/door frames up to false ceiling heaight. | | | | |
| | Framework shall be regidly secured to floor, bottom of slab & existng walls at 2'-0" c/c with dash fasteners. | | | | |
| 1.2 | 7' Height Glazed partition in Cash cabin | Sq.Ft. | 56.00 | | |
| | Same as of Solid ht. partition , providing Aluminium grill jalli above 1'-0" / 3'-0" & up to 7'-0" fixed with steam beech wood beading of finished size 1 1/2" X 1" all along the edge. All exposed woodwork to be mealamine polished. All as per the design and instruction Bank. | | | | |
| 1.3 | 4.5' Height Semi Glazed Partition manager cabin / Counter | Sq.Ft. | 160.00 | | |
| | Same as above but of Low height as per design including 10mm Toughened glass with edges polished to be used. All other specs are same as of above, Edges of the partition to be covered with 3" X 1.5" Steam beech wood duly melmine polished moulding. 38mm thick flush door: wicket gate also shall be included for a measurement. All as per the design and insturction bank. | | | | |
| 1.4 | Front Glazeing cash cabin | Sq.Ft. | 15.00 | | |
| | Providing & fixing 10mm thick toughened clear float glass to shape for front side of the cash counters including cutting the holes and providing & fixing TW beading polished and tinted to approved shade. (including SWO/Chief Cashier front Glass). | | | | |
| 1.5 | Aluminium grill on the ceiling of Cash cabin | Sq.Ft. | 40.00 | | |
| 2 | DOOR & ACCESSORIES | | | | |
| 2.1 | Main Entrance Door with Fixed Glazing | Sq.Ft. | 80.00 | | |
| | Providing and fixing aluminium entrance doors with 12mm floatglass (3M frosted sticker) as/design with top & bottom section of 45 by 90mm , 2mm thick section of hindalco/Jindal anodized in approved colour with 25 micron anodizing along with SS C shaped handles of kitch or equivalent make along with floor spring of hemco/everite make. The item also includes door lock completed to the satisfaction of the architect. | | | | |

| S.NO. | DESCRIPTION | UNIT | QTY. | RATE | AMT |
|-------|---|------|------|------|-----|
| 2.2 | Supplying and fixing of Dorma/GEZE Dline / Hardwyn/Godrej or approved equivalent Door Closer for wooden door for Cashier . | Nos | 1.00 | | |
| 2.3 | Supplying and fixing of mortice door lock of hardwyn make HML-480 Lock Body 304 Stainless Stell. (in BM Cabin , Store room 0. Cash cabin shall be Godrej Night latch. | Nos | 1.00 | | |
| 2.4 | Supplying and fixing of door stopper SS Grade 304, HESSF-2C hardwyn make. | Nos | 4.00 | | |
| 3 | WORKING COUNTER | | | | |
| 3.1 | CASH COUNTERS | Rft. | 5.00 | | |
| | Providing and fixing Chief Cash Counter in split-levels @ 2'-6" (height 750mm) & 18" (1140mm) with 2'-6" & 15" wide each respectively . Upper levels having shall be finished with 1.0mm thick laminate of approved shade and colour with approved adhesive to 19 mm thick commercial ply top. Edges of 18" wide counter shall be finished with 1.0mm thick laminate of approved shade and colour. Lower tier shall be made of 19 mm thick ply wood finished in 1.5mm thick laminate. Exposed edge having steam beech wood edging of size 1 ½" x 1". Vertical face shall have 19mm thick ply wood over pine wood framework as per requirement of design. All exposed surfaces shall be finished with 1.0mm thick laminate of approved shade and colour. | | | | |
| | 1 no. prefabricated metal computer key board tray including drawer slides 12.5" x 22" tray with 14" telescopic slides including L – brackets for securing to the table top. Chest of drawers (size 1'-4" x 2'-0" x 2'- 5") made of 19mm thick commercial ply wood having three drawers finished with 1.0mm thick Laminate on all sides. Each drawer shall have locking system and 6" long S.S. brushed finished handle, drawer slides etc. of approved make. All exposed edges of ply wood sealed with Steam beech wood beading of size ¼" x ¾". All beading and exposed wood shall be melamine polished and used 0.8 mm white laminate in internal surface . Item includes readymade metal powder coated CPU trolley, grommet, footrest for each seat. All complete as per approval and instructions of the Architect / employer.The rate also include providing and fixing a foot rest using hard wood 100 x 25mm size 1st class seasoned country frame. | | | | |
| | Payment will be made only on the centerline measurement. The rate shall include the cost of providing skirting of 100mm wide lined with 1.0mm thk laminate and providing & fixing a border at top of 100mm wide lined with 1.0mm thk laminate complete. | | | | |
| 3.2 | RUNNING COUNTER | Rft. | 9.00 | | |
| | Providing and fixing staff counter/SWO in split-levels @ 2'-6" (750 mm) & 3'1" with 2'-6" (750 mm) & 9" wide each respectively . Upper levels having surfaces shall be finished with 1.0mm thick laminate of approved shade. Lower tier shall be made of 19mm thick ply wood and finished in 1.5mm thick laminate. Working top having steam beech wood edging of size 1 ½" x 1". Vertical face shall have 19 mm thick commercial ply over pine wood framework as per requirement of design. All exposed edges of ply wood sealed with Steam beech wood beading of size ¼" x ¾". All exposed surfaces shall be finished with 1.0mm thick laminate of approved shade. | | | | |
| | The item includes Chest of drawers (size 1'-4" x 2'-0" x 2'- 5") made of 19mm thick commercial ply wood having One drawers at top and a storage cabinet below having shutters of 19mm thick ply wood finished with 1.0mm thick Laminate on all sides. 1 no. prefabricated metal computer key board tray including drawer slides 12.5" x 22" tray with 14" telescopic slides including L – brackets for securing to the table top for each seat. All beading and exposed wood shall be melamine polished and used 0.8 mm white laminate in internal surface . Item includes 1'-3" high 12mm thick toughened glass above upper tier and readymade metal powder coated CPU trolley, grommet, foot rest for each seat. All complete as per approval and instructions of the Architect / employer.The rate also include providing and fixing painting a foot rest using hard wood 100 x 25mm size 1st class seasoned country frame. Payment will be made only on the centerline measurement. | | | | |
| | The rate shall include the cost of providing skirting of 100mm wide lined with 1.0mm thk laminate and providing & fixing a border at top of 100mm wide lined with 1.0mm thk laminate complete. | | | | |

| S.NO. | DESCRIPTION | UNIT | QTY. | RATE | AMT |
|------------|--|--------|-------|------|-----|
| | | | | | |
| 4 | TABLE & FURNITURE | | | | |
| | | | | | |
| 4.1 | MANAGER TABLE (Size:- 6'-0" x 3'-0") ht. 2'-6" | Nos | 1.00 | | |
| | Providing and fixing tables made out of 19 mm thick commercial ply over hard wood frame work finished with 1 mm thick laminate of approved shade. Top having steam beech wood edging of size 2" x 1 3/4". 10mm thick clear float glass with beveled edges shall be provided on the finished to 19mm thk Comm.ply wood of approved make cladded with 1mm thk. laminate(color with vertical grain) as per design in all visible areas. All the exposed edges to be covered with wooden steam beech lippings and mouldings duly malamine polish. The drawers to be made out of 19mm thk ply wood with 1.0 mm laminate finish in the front , and bottom to be made out of 6mm plywood and it should play in drawer sliding telescopic channels. The inside of the drawer to be used 0.8 mm laminate & Table back side wil be 1mm laminate. A leg rest to be provided duly polished made out of 3"x2" Wooden Section. | | | | |
| | A shutter to be made by 19mm ply wood cladded with 1.0mm laminate .The necessary locks handles to be provided in each drawers and shutters. 3" x 1/2" wooden skirting to be provided in all visible areas duly polished. The necessary wire managers(SS) to be provided on the tables and provision for lights to be kept if required in the front of the table. All the exposed areas to be duly malamine polished The work to be completed as per design and approval of the Bank. The table should have key board tray and CPU Trolley to be Modular. All as per the design and instructions Bank . | | | | |
| 4.2 | OFFICER TABLE (Without glass top) (Size:- 5'-0" x 2'-6") ht. 2'-6" | Nos | 0.00 | | |
| 5 | STORAGE & SIDE UNIT | | | | |
| | | | | | |
| 5.1 | Side and Back Unit | | | | |
| | Providing and fixing Side Unit/ Back unit 400 mm depth made out of 19mm ply wood finished with 1.0mm laminate in all exposed areas and top shall be 1 mm thick . The drawers to be made out of 19mm commercial plywood and cladded with 1.0mm laminate and bottom made out of 6mm comm ply duly painted in matching tone and it should play on drawer sliding channels . The shutters to be made out of 19mm commercial ply wood and should play on drawer sliding castors on powder coated channels. The necessary locks , handles, etc to be provided . 3" x1/2 wooden skirting to be provided duly polished as per matching tone all along the visible areas . Inside of the unit to be used 0.8 mm white laminate . All the exposed edges of the boards/ply woods to be covered with woden lippings/mouldings duly polished all complete. The work to be completed as per approval and specification of the Architect. | NO | 1.00 | | |
| 5.2 | Storage | Sq.Ft. | 40.00 | | |
| | Providing and fixing Full /Low height Cabiner 525mm deep made out of 19mm thk plywood finished with 1.0mm laminate in all exposed areas . The Shutter to be made out of 19mm ply wood in the front cladded with 1.0mm laminate(color, vertical grain) . and bottom made out of 6mm plywood duly painted in matching tone and shelves 19mm thk comm ply wood to fixed inside storage. The shutters to be made out of 19mm ply wood . The necessary locks , handles, etc to be provided . 3" x1/2 wooden skirting to be provided duly polished as per matching tone all along the visible areas . Inside of the unit to be enamel paint finish . All the exposed edeges of the boards/plywoods to be covered with wooden lippings/mouldings duly polished all complete.All as per the design and instructions Bank. | | | | |

| S.NO. | DESCRIPTION | UNIT | QTY. | RATE | AMT |
|-------|---|--------|-------|------|-----|
| 6 | OTHER MISCELLANEOUS ITEMS | | | | |
| 6.1 | PIN UP / NOTICE BOARD | | | | |
| | Providing and fixing soft board with necessary framework with 12mm BWR plywood on top 12 jolly board to be fixed finished with fabric @Rs80 , with necessary mouldings duly polished along the periferi. All as per the design and instructions Bank. | NO | 1.00 | | |
| 6.2 | WRITING LEDGER & Cheque & sugestion box | NO | 1.00 | | |
| | Providing and fixing writing ledge as per design minium 5 ft length made out 19mm comm. board with necessary grove patterns with 1.0mm laminate. 10mm thk machine polished glass to be provided on top of the writing ledge. Small boxes to be made out of 12mm comm. ply to be made on top of the writing ledge finished with 1.0 mm laminate, inside enamel painted and rate should be included providing fixing of sugestion box & Cheque deposit box as per approval of bank .The work to be completed as per design and approval of the architect. | | | | |
| 6.3 | Main Electrical Panel Cabinet | | | | |
| | Providing and fixing of DB Shuttering formed of 12mm thk plywood wood on 12mm thick Gypsum board (fire Proof) with finsih as per Item no 1 for inside and out side shutters finished with laminate on outer surface with SS (4Nos) louvre perforation and necessary hardware,hinges etc complete as per details. All as per the design and instructions Bank. | Sq.Ft. | 35.00 | | |
| 6.4 | Shutter boxing for ROLLING SHUTTER | | | | |
| | P & F shutter boxing made of 19 m.m. phenol bonded ply IS 303 grade including hatch fir pulling down & up the rolling shutter.The box to be laminated with aluminium composite panel of 3.0 m.m. completed to the satisfaction of architect.Front surface will be taken for measurement only. | Sq.Ft. | 80.00 | | |
| 6.6 | Customer Table - (4'-0" X 2'-6") | | | | |
| | Providing and making a table of over all size of top as mentioned above. It shall consist of ¾" thk. Comm. Ply top as per design (double edge on outer edge with 1 1/2" thk half moulding on the edges) supported on ¾" thk. Comm. Ply verticals.supported on wooden base (as designed by the architect). Suitable wooden moulding as architect design with mellamine shall be provided to the edge of the top. All external surfaces to be finished in 1 mm laminate. | No. | 1.00 | | |
| 6.7 | ROLLING BLINDS | Sq.Ft. | 0.00 | | |
| | Providing and fixing Roller blinds of approved design and shade by the Architect,incl all std fittings as per manufacturer's specification. The work to be completed as per specification and approval of the architect. (approved brand Vista, Hunter Dogulus) | | | | |
| 6.8 | 7 feet ht column panelling | | | | |
| | Fabricating and fixing wall/column paneling, the framing shall made out of aluminium hollow section of 65mm x 37mm size 1.5mm thick of JINDAL / INDAL at spacing not exceeding 600mm bothways (horizontal and vertical). Paneling framework to be secured to wall surface/column surface.Paneling framework to be clad on one side with 9mm thick ply finished with 1.0mm thk laminate including skirting of 100mm high & 12mm x 12mm groove at skirting level. All as per the design and instructions Bank. | Sq.Ft. | 80.00 | | |
| | GRAND TOTAL FOR FURNISHING (A) | | | | |
| | * GST EXTRA AS APPLICABLE | | | | |

| | | | | | |
|--|--|------|------|--|--|
| | <div>Mohit & Associates. Architects,Interiors .Estimators L-2/554-, Vineet Khand, Gomti Nagar,Lucknow. Phone.9582218092 E-Mail: mohitg.gupta2783@gmail.com</div> | | | | |
| BILL OF QUANTITY FOR ELECTRICAL WORKS | | | | | |
| <u>FOR REFURNISHING OF UTTAR PRADESH GRAMIN BANK BRANCH AT BHARGAWAN- DISTRICT -SHAJAHANPUR(UP)</u> | | | | | |
| | A - Light, Fan, 16amp/6 amp points | | | | |
| 1 | Supply,laying,connection & testing of light,fan point, wiring by 2x1.5mmsq(2x3/.029) +1x1mmsq PVC insulated, multistrand single core copper conductor FRLS wire maintaining the colour code as per direction in PVC conduite of 20mm with ISI mark 1.5mm thickness to conceal in wall partition mending good the damage, complete with PVC circular box, bend to be done as per drawaing including 3 point ceiling rows wherever required GI saddle to be used for fixing,metal flexiable/PVC flexiable pipe may use if required in partition wall. All PVC pipes should be with ISI mark. No joints will be allowed inside pipe,light, fan & plug point complete with modular type switch plate & MS box . rate Including the main circuite line 2x2.5mmsq+1x1.5mmsq earth PVC insulated Cu. Wire from DB to switch board ,maintaining the colour code. Circuite line for lighting switch board & 6Amps plug board are to be drawn from lighting DB to Lighting board & plug point board (independent), 6/16 Amps plug point line are to be draw from power DB.as per DBschedule /SLD. | | | | |
| a) | light point | Nos. | 17 | | |
| e) | Ceiling fan point with step type electronic regulator | No | 7.00 | | |
| f) | Same as above, but for exhaust fan excluding regulator. | No | 2.00 | | |
| g) | Same as above 5A Point in the switchboard itself. | No | 8.00 | | |
| h) | same as above Wiring for call-bell point including buzzer | No | 1.00 | | |
| i) | Wiring (2x2.5mmsq+1x1.5mmsq from power DBs) for independant 6A multi pin socket at walls along with 6A modular type switches board housed in painted MS box (upto 3 independent plug points can be taken in one circuit). For wall Fan | No | 1.00 | | |
| 2.0 | Supply and installation of modular type 2 nos 6A & multi pin sockets with 2 nos 6 Amp one way switch housed in MS box to be fixed in partitions or concealed in wall. The box shall be painted with 2 coats of enamel paint over a coat of red oxide primer including wiring for Raw power socket outlet using 2 R runs of 2.50 Sqmm and single run of 1.5 sqmm PVC insulated multi stranded single core copper conductor FRLS wire in 20mm PVC conduit to be laid in floor, partitions, etc. complete with all accessories (looping 2 sets of 2x6A socket outlet in one circuit- from DB) (Raw power). for counter | Each | 4 | | |
| 3 | Supply and installation modular type 16A, 5-pin socket with 16A one way switch housed in MS box to be fixed in partitions or concealed in wall. The box shall be painted with 2 coats of enamel paint over a coat of red oxide primer , the rate shall include wiring fusing 2R 4.0 sqmm & single run of 2.5 sqmm PVC insulated multi stranded single core copper conductor FRLS wire in 25mm PVC conduit to be laid in floor, partitions, etc complete with all accessories (for line printer : or optional).(upto 2 independent plug points can be taken in one circuit) | Each | 6 | | |
| B - AIR CONDITIONING | | | | | |
| 1 | AC POWER PLUG POINT Supply and Installation of 15A modular type socket separately controlled by 32A Modular type DP indicator switch with suitable metallic box for the local control of the Split AC including Wiring using 2x4Sq.mm along with 1x2.5 Sq.mm pvc insulated copper wire through 20mm PVC (ISI- H) conduit. | Job | 3 | | |
| C - UPS | | | | | |

| | | | | | |
|----|---|----------|----|--|--|
| 1 | S/laying of 4 core 10 sq.mm PVC armoured Aluminium conductor cable from main Panel to 4way TPN Db in the UPS room to be laid in 25/32mm heavy duty PVC conduit/ pipe & run on surface or concealed in wall/ floor/ false ceiling. (Finolex/Skytone/ Cable corp.) | m | 15 | | |
| 2 | Supply & fixing flush type Single door IP20 4way TPN distribution board for regulating UPS supply complete with 63A TP MCB as incomer & 2nos. 32A DP MCB as outgoing (Assumed 2nos. 5Kva UPS - one Hot & one Sb.) | Each | 1 | | |
| 3 | Supply & laying of incoming & outgoing wiring to & from UPS with 2x 4.0sq.mm + 1x 1.5sq.mm (earthing) stranded Cu. wire conductor (Finolex/Anchor/Skytone) to be laid in 20/25 mm flexible PVC pipe heavy duty to UPS incoming & from UPS outgoing to DP MCB in 16way SPN Db. | m | 8 | | |
| 4 | Supply & fixing of 12way SPN Db flush type single door IP 20 - MDS/ Hagers/ Siemens complete as under | Each | 1 | | |
| | Incoming - 32A DP MCB - 1Nos. | | | | |
| | 6Nos. - SP 6/10A MCB of 10ka rating (MDS/ Hagers/ Siemens/ ABB) | | | | |
| 5 | Supply & fixing of 4nos. 6A switches & sockets (Modular)complete with computer point circuit wiring with 2x2.5sq.mm + 1x 1sq.mm stranded Cu. Single core Copper conductor (Finolex/Anchor/RPG) to be laid in 19mm M S conduit pipe heavy duty 16swg or 1" PVC casing capping vertical drops heavy duty laid & concealed in wall/ floor/ panelling/ partitions or above false ceiling as per requirement. | Per Node | 6 | | |
| | D - DISTRIBUTION MAINS | | | | |
| 1 | S/F of 3 nos. 100Amps Kit kat set link type with heavy duty neutral link and making its connection from electronic meter c/w wooden board etc. | Set | 1 | | |
| 2 | Supply & fixing 63 amp TP Rotary switch for UPS incomer main line make Havells | NO | 1 | | |
| 2a | Supply & fixing 63 amp sp changeover for incomer main line & Generator make Havells | NO | 1 | | |
| 3 | Main cabling work from fuse Kit kats to Panel: Supply, laying, testing & commissioning of 4c x 16sq. mm XLPE insulated Aluminium conductor armoured cables from 100A link type fuse kit kats to the incoming of the main Panel including effecting proper connections with lugs, The armouring should be connected at both ends properly with Panel body and TPN Db body. The cable should be laid on surface with proper clamps or laid & concealed in wall/ floor/ paneling/ false ceiling complete in all respect. The work also includes cutting chases for conduits in the wall/ floor (Without damaging the building) along with clamping the cable at every 450mm interval & finally finishing the surface & matching the same with the existing surface. The rate should include the cost of all materials, labour, T&P, taxes, levies, scaffolding, shifting of furniture, carting away the debris and cleaning the floor etc. The job shall be complete & to the entire satisfaction of the Bank/Architect. | m | 5 | | |
| | | | | | |
| 4 | S/ laying of XLPE insulated armoured Al. Conductor cable including cost of lugs, cable glands etc. | | | | |
| | 4c x 10sq.mm for 4way TPN Db for PP Db | m | 10 | | |
| 5 | Supply, installation, testing & commissioning of flush mounted 4way TPN distribution boards double door IP -42 for PP complete in all respects as under - Siemens/ MDS/ Hagers | Each | 1 | | |
| | Incomer - 63A TP MCB 10 KA Rating - (Siemens/ MDS/ Hagers/ Schnider) neutral to be directly connected to neutral bus | | | | |
| | Outgoing | | | | |
| | R - 16/ 16/16A | | | | |
| | Y - 16/ 16A | | | | |
| | B - 16/ 16A | | | | |
| | Blanking Plates - 5nos. | | | | |

| | | | | | |
|--------------|---|-------------------------------|----|--|--|
| 6 | AC DB : Supply, Installation, testing and commissioning of wheather proof 4 Way double door TPN DB of approved make with all necessary inter connections consisting of the following for AC load. Each terminals on MCB should be connected with Aluminium Leg | | | | |
| | Incoming : 63A 4P RCCB (300mA) -1 No. | | | | |
| | Outgoings: 20 A SP MCB -2Nos. (1TR AC) | | | | |
| | 32 A SP MCB -4Nos. (1.5TR AC) | Each | 1 | | |
| 7 | Glow sign Board - Circuit wiring with 2x4sq.mm + 1x 2.5sq.mm stranded Cu. conductor (Finolex/Anchor/Skytone) to be laid in 19mm M S conduit pipe heavy duty 16swg laid & concealed in wall/ floor/ panelling/ partitions or above false ceiling as per requirement. The rates should include the cost of all materials, labour, T&P, taxes & levies, scaffolding, shifting of furniture, carting away the debris and cleaning the floor etc.The job shall be complete & to the entire satisfaction of the Bank. | m | 6 | | |
| | F- EARTHING | | | | |
| 1 | Supply, Installation, Testing and Commissioning of Maintenance Free Earthing system made up of copperbonded rod of 10 feet length,23 mm dia. (Minimum copper bonding shall be 0.25mm) along with Rod-toConductor connectors, Earth enhancement material, Pit Cover and other accessories as required and as per specification and other applicable codes (include chamber for earthing, Earthing certificate to be submitted along with the bill). | Job | 2 | | |
| 2 | Supplying, laying & fixing of 10 sq mm. copper pvc insulated wire covered with GI pipes from earthing plate to main panel.if required beyond 10m | Per M. | 20 | | |
| | G - SUPPLY & FIXING ITEMS | | | | |
| 1 | S/F 4ft 20 w Led Tube light fitting - Phillips ,WIPRO make approved by Bank/ Architect | Each | 15 | | |
| 2 | S/F of angle holder for bulbs including cost of 15 w led lamp | Each | 2 | | |
| 3 | S/F of wall mounted fan 400mm sweep with switch &socket -Bajaj/ Crompton/ Alsthom | Each | 1 | | |
| 4 | Supplying & Fixing 1200mm dia Ceiling Fans usha Model Senator Max colour specified by the bank with all necessary fitting like U hook,Rod for hanging, length as/site required. | Each | 7 | | |
| 5 | Supply & Fixing of Exhaust fresh air fan 300mm - Crompton Greaves/ Usha/ Khaitan/ Bajaj | Each | 2 | | |
| | | | | | |
| | Total Cost of works | | | | |
| | * GST EXTRA AS APPLICABLE | | | | |
| | Note - 1) All electrical items body earthing connections to be made properly & checked throughly. | | | | |
| | 2) All cable connections to be properly terminated thru lugs. | | | | |
| | LIST OF APPROVED MAKES/ BRANDS | | | | |
| S. No | Description | Approved make | | | |
| 1 | Electrical Fittings | Philips/Wipro/havils/crompton | | | |
| | | | | | |
| 2 | Electrical Switches | MK India/ North West | | | |
| | | | | | |
| 3 | Electrical Conduits(FLRS) | Setia/ AKG | | | |
| | | | | | |
| 4 | Fans | Crompton/ Equivalent | | | |
| | | | | | |
| 5 | Electrical Wiring(FLRS) | Anchor/ Skytone/ Finolex | | | |

Mohit & Associates.

Architects, Interiors .Estimators

L-2/554-, Vineet Khand, Gomti Nagar, Lucknow.

Phone.9582218092,74282817659

E-Mail: mohitg.gupta2783@gmail.com

**DETAILED SPECIFICATIONS & ESTIMATE
OF UTTAR PRADESH GRAMIN BANK BRANCH AT BHARGAWAN-DISTRICT -
SHAJAHANPUR(UP)**

| A | DATA CABLING WORK | | | | |
|-------|---|------|------|---------|---------|
| S.No. | DESCRIPTION | QTY | UNIT | RATE | TOTAL |
| | | | | (In Rs) | (In Rs) |
| | | | | | |
| 2.2 | Wiring for computer networking from I/O hub to computer workstation with UTP Cat-6 computer cable including providing ferrules at both ends and termination at both ends including providing & fixing frame for with shutter, RJ 45 outlet, faceplate and mounting box complete of modular type, This work includes providing PVC conduits (1/2", 3/4" size or as required) in chases from the I/O hub to the point. The cost includes testing, commissioning etc complete. Note : Do not run more than 3 wire in single pipe & should be concealed. | Nos. | 6 | | |
| 2.3 | Supply of Cat - 6 D-Link patch cord 7' 0" | Nos. | 6 | | |
| 2.4 | Supply of Cat - 6 D-Link patch cord 3' 0" | Nos. | 6 | | |
| 2.5 | Supply & fixing 24 Port Jack Panel Make:-D-Link | Nos. | 1 | | |
| 2.6 | 9U Rack with Glass Door , Locking system Make: APW Make:-D-Link | Nos. | 1 | | |
| 2.7 | 24PORT 10/100Mbps Switch Make:-D-Link | Nos. | 0 | | |
| | | | | | |
| | TOTAL | | | | |