

सेवा में

मुख्य प्रबंधक

आईटी विभाग

उत्तर प्रदेश ग्रामीण बैंक

प्रधान कार्यालय लखनऊ

महोदय

विषय: एटा परिक्षेत्र के अंतर्गत ढोलना शाखा में इलेक्ट्रिकल वायरिंग, यूपीएस वायरिंग एवं डाटा केबलिंग कार्य हेतु टेंडर को बैंक की वेबसाइट पर प्रकाशित करवाने के सम्बन्ध में।

विषयक के सम्बन्ध में आपके संज्ञान में लाना चाहते हैं कि एटा परिक्षेत्र के अंतर्गत ढोलना शाखा में इलेक्ट्रिकल वायरिंग, यूपीएस वायरिंग एवं डाटा केबलिंग कार्य हेतु टेंडर आमंत्रित किये जाने हैं।

अतः आपसे निवेदन है कि संलग्न टेंडर दस्तावेजों को बैंक की वेबसाइट पर प्रकाशित करवाने का कष्ट करें।

सादर,



क्षेत्रीय प्रबंधक

क्षेत्रीय कार्यालय एटा



TENDER NOTICE**Tender for Electrical, UPS wiring & Data Cabling work in Dholna branch under Uttar Pradesh Gramin Bank, Regional office Etah.****(Only empanelled vendor can quote)**

Uttar Pradesh Gramin Bank, RO Etah invites your competitive rates for the electrical wiring, UPS wiring & Data Cabling work at the premises of following branch situated in Etah Region.

S No	BRANCH	BRANCH STATUS	REGION	PREMISES	ARCHITECT	Br CUG No
1	DHOLNA	READY	ETAH	NEW	GUNJAN & ASSOCIATES, LUCKNOW	8173900401

Terms & Conditions

1. The rates quoted should be inclusive of all types of changes, expanses, FOR at the branch. The GST if applicable will be paid extra.
2. Please quote your competitive rate on the enclosed formats. Kindly mention "TENDER FOR ELECTRICAL WORK, UPS WIRING WORK and DATA CABLING WORK FOR DHOLNA BRANCH" on the separate envelope.
3. If it is found that the material used is not the same as mentioned in quotation then the bank has the right to reject the work and material
4. If any type of change is required in said work it should be duly approved by the Regional Manager of Etah Region
5. If the rates quoted by you are accepted to the bank than the said work is to be completed in given time, Please ensure that if the work is not completed in given time then the bank has the right to impose the penalty at the rate of 5.00% for 7 days delay.
6. Rates quoted will be valid for 180 days from the date of opening of quotation.
7. Please ensure the measurement, quantity, items are tentative and may increase or decrease as per the requirement of bank. The variation may be upto 20%.
8. After the work is completed it will be duly verified by the Branch Manager, concerned branch as well as the Architect authorized for supervision/verification of work at the Etah Region
9. Please ensure that the bank will not provide any advance against the work order however payment in full or in parts will be made only after the work completed and verified by the Architect and official of P&E Department (RO Etah) .
10. Please ensure that before starting the work at the branch , the raw material may be duly verified by the official of P&E Department (RO Etah) & panel architect.
11. Please ensure that quoting the lowest rate is not necessary, bank may allot the work and in this regard the bank has the full right to accept or reject the one and all tenders without any notice.
12. The architect for electrical, ups wiring & Data cabling work at branches in Etah Region is GUNJAN & ASSOCIATES, LUCKNOW.



क्षेत्रीय कार्यालय: 12/04, बड़े काली मंदिर के पास, कल्याण मार्ग (ठंडी सड़क) एटा - 207001
 Regional Office: 12/04, Near Bada Kali Mandir, Kalyan Marg (Thandi Sadak), Etah - 207001,
 E-mail: ans.roetah@aryavartbank-rrb.com

Ref: UPGB/ROEtah/206/2025-26

Specification of Materials:

1. MCCB	:MDS legrands, ABB, GE, SIEMENS
2. Changeover	: Indo Asian/ HPL Socomec / GE/ Standard stangaurd
3. Distribution board	: MDS / Standard / Indo Asian / HPL
4. MCB	:MDS / Standard / Indo Asian / HPL
5. Cable	: Gloster / Rallison / Incab / CCI
6. Copper wire	:Rallison / Finolex / Polycab / R.R. Cable
7. Switch / Socket / Call bell and accessories	: Anchor / Havells / CPL / MDS / Philips / Simon
8. Electrical Light Fittings / Fixtures Complete	: LED-Crompton / Panasonic
9. Wall Fan / Ceiling Fan / Exhaust Fan	: Ceiling Fan =Bajaj / Crompton Wall Mounted Fan
Crompton / Alstrom (Metalic Body)	

Submission of Tenders:

Please submit your competitive rates in closed envelope to **The Regional Manager, Uttar Pradesh Gramin Bank, Regional Office, 12/04 Kalyan Marg (Thandi Sadak) Etah (207001), Mob. 8173900396** positively on or before **28.07.2025** and the tender will be opened on dt. **29.07.2025** at Regional Office Etah on 11:00 am in presence of committee member. All Vendors (who quoted rates) are requested to remain present at the time of opening of tenders. Plese note that no seprate invitation will be sent.

SR. MANAGER

P&E DEPARTMENT

RO ETAH



Gunjan and Associates
Architects, Engineers, Interiors
& Landscape Designers

141, Sainik Nagar, Raibareilly Road, Lucknow-226002

Phone: 0522-3553324, 9838818489

E-mail: studio@gunjanandassociates.com

URL: www.gunjanandassociates.com

BILL OF QUANTITY FOR ELECTRICAL WORKS

FOR ARYAVART BANK, BRANCH DHOLNA, RO ETAH.

S.NO.	DESCRIPTION OF ITEM	QTY	UNIT	RATE (Rs.)	AMOUNT (Rs.)
1	SITC of 100Amp Kit kat Fuse unit 3 nos with 100 Amp neutral link on wooden board (3' x 3') complete with connections (new).	1	Set		
	ELECTRICAL PANEL/Db				
2	ELECTRICAL DISTRIBUTION Db SITC of 6way Vertical TPN DB complete with 100Amp 16kA TPN MCCB as Incomer, 63A TP 10kA MCB -4 Nos and 6-16Amp S.Pole 10kA MCB-3 Nos as outing complete in all respects as required The job shall be completed, to the satisfaction of the Bank Engineer/Architect.	1	Set		
3	<u>Changeover</u> : SIF of 63A 4P changeover near Main Db for regulating DG supply including proper connections.	1	Each		
LOM	Changeover Switch- C&S/ Havells/ L&T/ HPL				
3	UPS I/P, O/P AND DISTRIBUTION				
a.	SITC of 40/32 AMP industrial socket along with DPMCB for UPS & Inverter I/P, O/P	2	Nos.		
b.	SITC of 12 WAY SPN DB Double Door (1 No. 40 AMP DP MCB and 10 NOS. 6-10 AMP SPMCB) (Branch UPS Power Distribution for UPS Points of CCTV System in at Manager Cabin (2nos.), and Staff counters (6nos.). F&B Alarm System (2nos.) and 9U Rack (1nos.).	1	Nos.		
c.	SITC of 63Amp Rotary Phase selector switch complete with RYB indication lifht in incloser complete in all respects as required. (Branch UPS)	1	Nos.		
4	RAW POWER & FAN, LIGHTING DB & AC DISTRIBUTION BOARD				
a.	4 WAY TPN DB Double Door (1 No. 20 AMP TP MCB and 12 Nos. 6-10 AMP. SPMCB in each outgoing circuit for Light, Fan & 6A Socket 15A Power Points,) all complete.	1	Nos.		
5	CABLES				
a.	SITC of 3.5 Core 25.0 Sq.mm Aluminium Armoured Cable (From Electric Meter to Electric Panel), complete with end termination and all respect as required.	10	Mtr.		
b.	SITC of 4 x 6.0 Sq.mm Copper Wire + 1 x 4.0 Sqmm Copper Earth Wire (Panel to UPS Incomer, LDP and UPSDB) in PVC Pipe fixing on walls or chassing the walls and making it good with cement mortar of 1:5 ratio and painting compete with end termination/lugs and in all respect as required.	75	Mtr.		

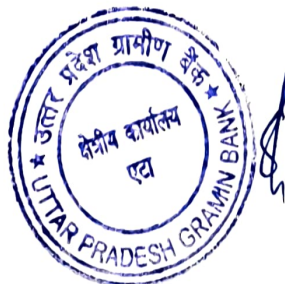

c.	SITC of 2 x 6.0 Sq.mm Copper Wire + 1 x 2.5 Sqmm Copper Earth Wire (Rotary Switch to UPS and UPS to UPS DB) in PVC Pipe fixing on walls or chassing the walls and making it good with cement mortar of 1:5 ratio and painting compete with end termination/lugs and in all respect as required.	55	Mtr.		
7	EARTHING				
a.	PIP technology GEL type 50mmdia 3000mm long earth electrod. One Earthing for Neutral grounding,	2	Nos.		
b.	4 Sq.mm Copper Earth Wire from earthing pit /Earth terminal to load point (UPS DB and Main DB etc)	50	Mtr.		
8	UPS POINT				
a	Supply & Installation of point wiring for Primary UPS or stabilized power plug points on workstations / table for computers using 3 x 1.5 Sq.mm copper conductor multi starnd FR PVC sheathed flexible wire pulled through floor raceways/conduit and taken upto table top using PVC rigid or flexible conduits run within wooden/metal partitions. Each point consisting of 2 nos of 10A 3 pin sockets, 1 nos 16A 2/3 pin sockets, 1 nos 16A Switch (Modular) & 1 nos Indicator, wired together forming one point. The earth wire of green color only. No secondary UPS Points to be made.	9	Nos.		
9	RAW POWER POINT 16A SOCKET POINT IN WALL ONLY				
a.	Supply & Installation of point wiring for Primary Raw power plug points on walls only for computers using 2X4+1X2.5 Sq.mm copper conductor PVC sheathed flexible wire pulled through already laid floor raceways and taken upto table top using PVC rigid or flexible conduits run within wooden/metal partitions. Each point consisting of 2 nos of 16A 2/3/5 pin socket & 2 nos 16A Switch (Modular), wired together forming one point. The earth wire of green color only. No secondary Points to be made. <u>(Only 1cash,2B.M, 4Officer,1router)</u>	7	Nos.		
b	Strong room controlling DP MCB - Circuit wiring with 3*1.5sq.mm FRLSH Cu stranded wires to be laid in 20 mm OD PVC medium duty laid & concealed in wall/ floor/ panelling/ partitions or above false ceiling as per requirement. The job also includes supply & fixing of 32A 2P MCB in 2way metallic box including connections with lugs. The job shall be complete & to the entire satisfaction of the Bank.	1	Job		
	PVC Insulated FRLSH Copper wire (ISI Marked)- Skyline/ Finolex/ Havells/ Polycab				
	PVC Conduit- CAP/ BEC/ Sieko/ AKG				
	MCB 10kA "C" Characteristics L&T/ Siemens/ Schnider/ Legrand				
10	LIGHT/FAN POINT				
	Supply & Installation of concealed point wiring using 600v grade 1.5 Sq.mm copper conductor PVC insulated wires (with proper R,Y,B color code) pulled through heavy gauge PVC conduits laid concealed over false ceiling including 2 Nos. 2.5 sqmm circuit wires from the relevant DB and also including 2.5 sqmm green color copper earth wire and switch plate, switches, etc. as approved by the Bank's Engineer/Architect.				
a.	Primary light points including the cost of 10 A modular switch	29	Nos.		
c.	Ceiling Fan Point including the cost of 10A modular Switch along with 4/5 step electronic fan regulator.	10	Nos.		
d.	Wall Fan Point along with 10 AMP modular switch	7	Nos.		
e.	Exhaust Fan Point along with 10 AMP modular switch	2	Nos.		
f.	6/10A Switch with 5pin 10A socket in counter, light & fan board	6	Nos.		

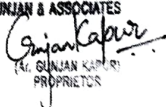

11	DATA CABLING & POINT THERE MUST BE MINIMUM 3FEET DISTANCE BETWEEN DATA AND				
	Supplying and laying of D-Link make CAT-6 (UTP) cable through trenches / conduits.				
a.	Supplying and laying D-link make CAT-6 Cable complete with CAT-6 Information outlet with plate & suface Box at individual Tables	9	Nos.		
b.	Supplying and fixing of 2 mtr long crimped patch cord	9	Nos.		
e.	SITC of 9U Rack including wire manager, power supply card, hardwares etc. complete in all respects	1	No.		
13	FIXTURES				
	SITC of following fixtures as per make list				
a	LED Tube Light Patti Type (white) - 20 Watts Make/ Brand as per MAKE LIST	29	Nos.		
b	LED Bulb with holder (white) - 9 Watts	2	Nos.		
c.	Ceiling Fan - 900mm Make/ Brand as per MAKE LIST	10	Nos.		
d.	Exhaust Fan Metal Body - 300mm Make/ Brand as per MAKE LIST	2	Nos.		
e.	Wall Mounted 80/100 watt plastic body Fan - 400mm, 1300 to 1500RPM Make/ Brand as per MAKE LIST	7	Nos.		
	TOTAL (excl. GST) (Rs.)				
Note: All rates are excluding G.S.T.					
<div style="text-align: right;"> For GUNJAN & ASSOCIATES  Ar. GUNJAN KAPUR PROPRIETOR </div>					
Ar. Gunjan Kapur					
For M/s Gunjan & Associates					



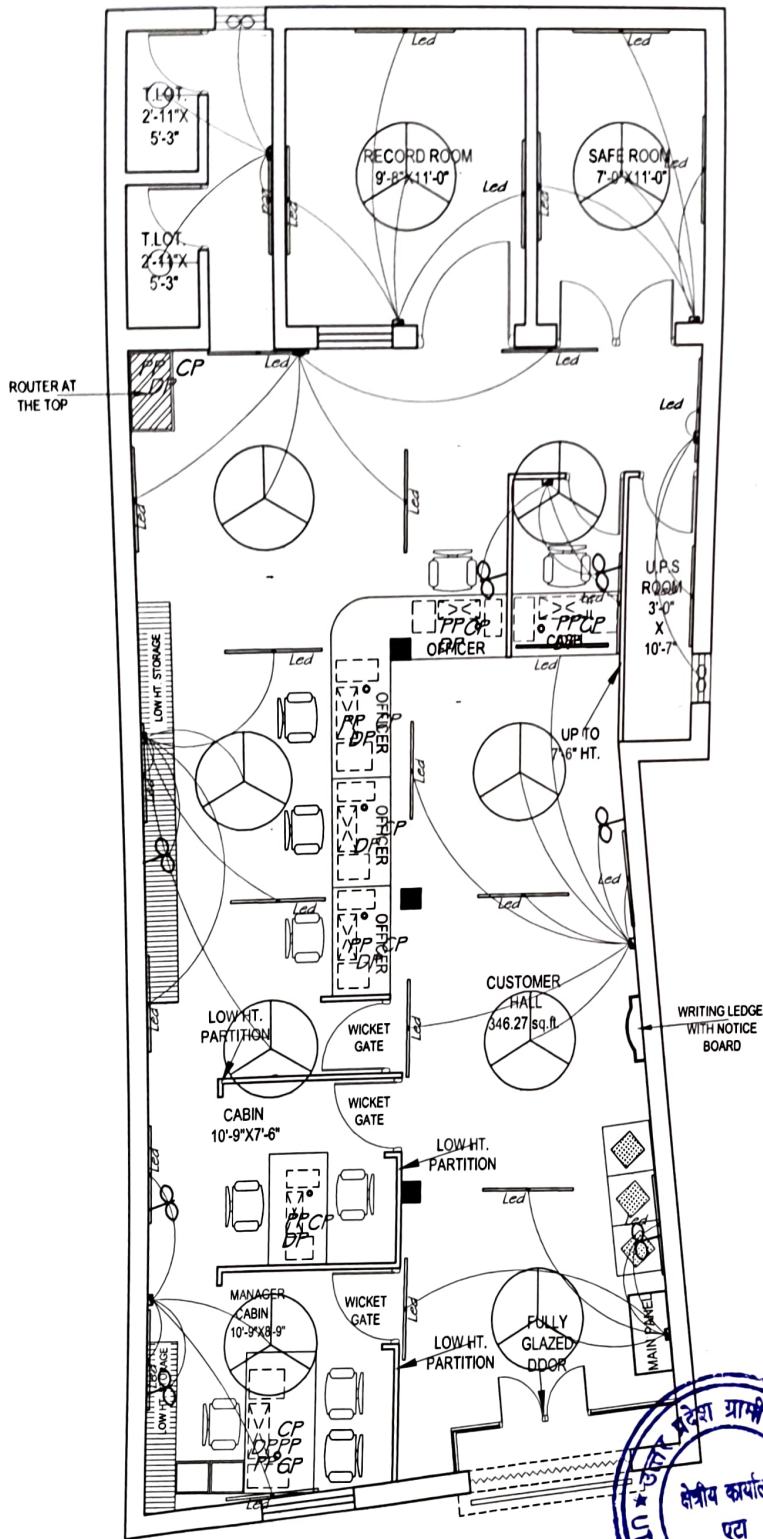

**Db & AC LOCATIONS
TO BE APPROVED
BY ARCHITECT**

LEGENDS FOR FALSE CEILING BRANCH

S.NO	SYMBOL	DESCRIPTION	HT.
1.	—	4' long LED Tube Light	7'-0"
2.		CEILING FAN	-
3.		WALL MOUNTED FAN	6'-6"
4.		EXHAUST	8'-6"
5.		1X11W CFL WALL LIGHT	8'-6"
6.		SWITCH BOARD	4'-6"
7.		POWER POINT	1'-0"
12.		MAIN LT INCOMING PANEL	
13.		TPN Db	6'-0"
14.		SPN Db	

PROJECT:-

ELECTRICAL REVISED LAYOUT
PLAN FOR
ARYAAVART BANK BRANCH
AT,DHOLNA,
R.O.ETAH.

DRG. TITLE:-

GROUND FLOOR

DATE:-

FEB -2025

NORTH:-

DRAWN BY:-

ARCHITECT:-

GUNJAN & ASSOCIATES
ARCHITECTS, ENGINEERS, INTERIOR
AND LANDSCAPE DESIGNERS.
141, SAINIK NAGAR, LANE NO-9,
RAEBARELI ROAD LUCKNOW-226002
Telephone No:- +0522-3553324
Phone No:- +9838818489, 9839018489
E-Mail:-studio@gunjanandassociates.com
Web:-www.gunjanandassociates.com